

# COPPER PRESS FIT FITTINGS (M PROFILE)

COMPLY WITH BSEN1254-2: 1998

## REDUCER MXF

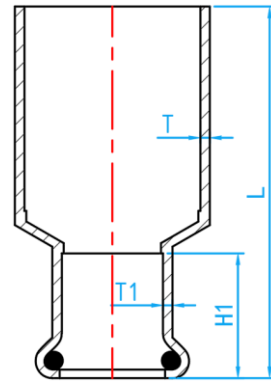
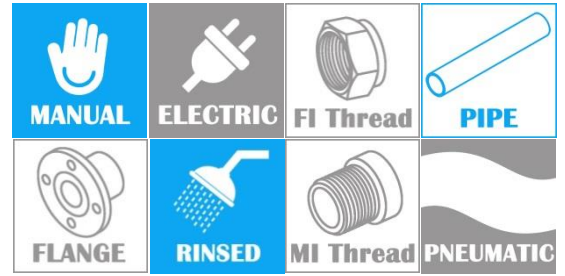

CROSS SECTIONAL VIEW

### DIMENSIONS

SKU	SIZE (mm)	H1 (mm)	L (mm)	T (mm)	T1 (mm)	WEIGHT (Kg)	PCS/CTN
PFNRS02015MF	22×15	20.0	50.0	1.5	1.5	0.036	300
PFNRS02515MF	28×15	20.0	54.0	1.5	1.5	0.045	250
PFNRS02520MF	28×22	21.0	52.0	1.5	1.5	0.053	160
PFNRS03520MF	35×22	21.0	59.0	1.5	1.5	0.072	120
PFNRS03525MF	35×28	23.0	58.0	1.5	1.5	0.074	100
PFNRS04220MF	42×22	21.0	66.0	1.5	1.5	0.092	80
PFNRS04225MF	42×28	23.0	66.0	1.5	1.5	0.095	70
PFNRS04235MF	42×35	26.0	65.0	1.5	1.5	0.101	60
PFNRS05020MF	54×22	21.0	81.0	1.5	1.5	0.148	60
PFNRS05025MF	54×28	23.0	79.0	1.5	1.5	0.160	60
PFNRS05035MF	54×35	26.0	78.0	1.5	1.5	0.160	40
PFNRS05042MF	54×42	30.0	76.0	1.5	1.5	0.160	40
PFNRS06525MF	67×28	23.0	96.0	2.0	1.5	0.270	20
PFNRS06535MF	67×35	26.0	95.0	2.0	1.5	0.270	22
PFNRS06542MF	67×42	30.0	96.0	2.0	1.5	0.270	20
PFNRS06550MF	67×54	35.0	98.0	2.0	1.5	0.270	20
PFNRS08035MF	76×35	26.0	104.0	2.0	1.5	0.345	18
PFNRS08042MF	76×42	30.0	103.0	2.0	1.5	0.345	15
PFNRS08050MF	76×54	35.0	108.0	2.0	1.5	0.365	15
PFNRS08065MF	76×67	50.0	113.0	2.0	2.0	0.450	15