

STAINLESS STEEL 316L PRESS FIT FITTINGS (M PROFILE)

COMPLY WITH BSEN1254-2: 1998
AS/NZS 4020: 2005
ASTM E 1086: 2014
SS 375: 2015
SS 270: 2015
BS 4504 PN16

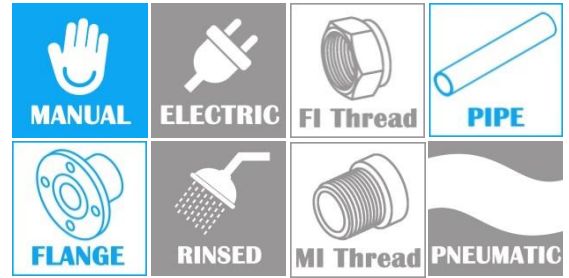

PRESSFIT FLANGE SOCKET

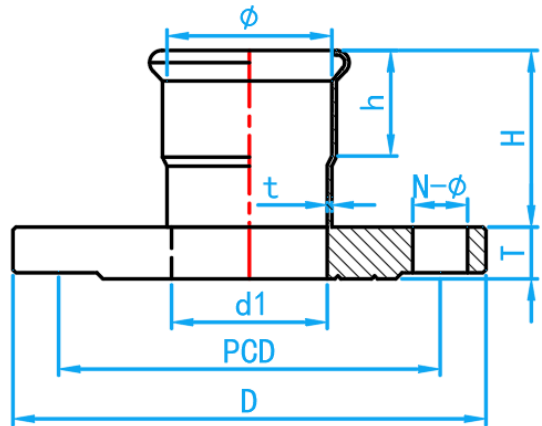

CROSS SECTIONAL VIEW

DIMENSIONS

STOCK CODE	∅ (mm)	D (mm)	PCD (mm)	d1 (mm)	NO.S OF HOLS	d (mm)	T (mm)	H (mm)	h (mm)	t (mm)	WEIGHT (kg)
SS316LPFNFLS01515	15	95	65	12	4	14	14	26	20	1.5	-
SS316LPFNFLS02020	22	105	75	18	4	14	16	28	21	1.5	-
SS316LPFNFLS02525	28	115	85	25	4	14	16	30	23	1.5	1.000
SS316LPFNFLS03535	35	130	100	32	4	18	18	33	26	1.5	1.100
SS316LPFNFLS04242	42	140	110	39	4	18	18	43	31	1.5	1.500
SS316LPFNFLS05050	54	155	125	51	4	18	19	43	36	1.5	1.800
SS316LPFNFLS06565	67	175	145	72	4	18	18	68	50	2.0	2.400
SS316LPFNFLS08080	76	190	160	85	8	18	20	70	51	2.0	3.100
SS316LPFNFLS100100	108	210	180	104	8	18	22	95	75	2.0	3.700