

STAINLESS STEEL 316L PRESS FIT FITTINGS (M PROFILE)

COMPLY WITH BSEN1254-2:1998
AS 3688:2005
AS/NZS 4020:2005
ASTM E1086:2014
SS 375:2015
SS 270:2015

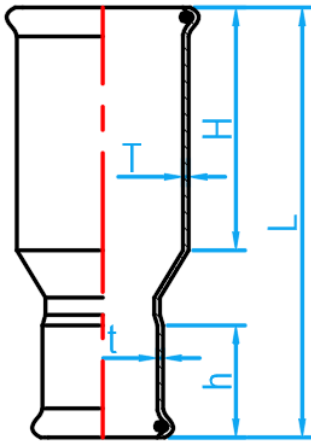

REDUCEING SOCKET



CROSS SECTIONAL VIEW

DIMENSIONS

| SKU | SIZE (mm) | L (mm) | H (mm) | h (mm) | T (mm) | t (mm) | WEIGHT (kg) | PCS/ CTN |
|------------------|--------------|-----------|-----------|-----------|-----------|-----------|----------------|-------------|
| SS316LPFNRS02015 | 22×15 | 61 | 21 | 20 | 1.5 | 1.5 | 0.054 | 200 |
| SS316LPFNRS02515 | 28×15 | 65 | 23 | 20 | 1.5 | 1.5 | 0.068 | 160 |
| SS316LPFNRS02520 | 28×22 | 65 | 23 | 21 | 1.5 | 1.5 | 0.075 | 130 |
| SS316LPFNRS03515 | 35×15 | 70 | 26 | 20 | 1.5 | 1.5 | 0.087 | 160 |
| SS316LPFNRS03520 | 35×22 | 70 | 26 | 21 | 1.5 | 1.5 | 0.083 | 120 |
| SS316LPFNRS03525 | 35×28 | 68 | 26 | 23 | 1.5 | 1.5 | 0.097 | 80 |
| SS316LPFNRS04215 | 42×15 | 78 | 31 | 20 | 1.5 | 1.5 | 0.110 | 120 |
| SS316LPFNRS04220 | 42×22 | 76 | 31 | 21 | 1.5 | 1.5 | 0.122 | 130 |
| SS316LPFNRS04225 | 42×28 | 76 | 31 | 23 | 1.5 | 1.5 | 0.125 | 100 |
| SS316LPFNRS04235 | 42×35 | 77 | 31 | 26 | 1.5 | 1.5 | 0.133 | 70 |
| SS316LPFNRS05015 | 54×15 | 90 | 36 | 20 | 1.5 | 1.5 | 0.166 | 70 |
| SS316LPFNRS05020 | 54×22 | 186 | 36 | 21 | 1.5 | 1.5 | 0.162 | 70 |
| SS316LPFNRS05025 | 54×28 | 90 | 36 | 23 | 1.5 | 1.5 | 0.175 | 100 |
| SS316LPFNRS05035 | 54×35 | 88 | 36 | 26 | 1.5 | 1.5 | 0.180 | 70 |
| SS316LPFNRS05042 | 54×42 | 94 | 36 | 31 | 1.5 | 1.5 | 0.207 | 70 |
| SS316LPFNRS06525 | 67×28 | 114 | 50 | 23 | 2.0 | 1.5 | 0.320 | 25 |
| SS316LPFNRS06535 | 67×35 | 115 | 50 | 26 | 2.0 | 1.5 | 0.322 | 25 |
| SS316LPFNRS06542 | 67×42 | 117 | 50 | 31 | 2.0 | 1.5 | 0.338 | 25 |
| SS316LPFNRS06550 | 67×54 | 119 | 50 | 36 | 2.0 | 1.5 | 0.347 | 36 |
| SS316LPFNRS08025 | 76×28 | 126 | 51 | 23 | 2.0 | 1.5 | 0.420 | 20 |
| SS316LPFNRS08035 | 76×35 | 130 | 51 | 26 | 2.0 | 1.5 | 0.425 | 20 |
| SS316LPFNRS08042 | 76×42 | 135 | 51 | 31 | 2.0 | 1.5 | 0.435 | 20 |
| SS316LPFNRS08050 | 76×54 | 129 | 51 | 36 | 2.0 | 1.5 | 0.454 | 36 |
| SS316LPFNRS08065 | 76×67 | 141 | 51 | 50 | 2.0 | 2.0 | 0.590 | 20 |
| SS316LPFNRS10042 | 108×42 | 158 | 75 | 31 | 2.0 | 1.5 | 0.790 | 12 |
| SS316LPFNRS10050 | 108×54 | 162 | 75 | 36 | 2.0 | 1.5 | 0.810 | 12 |
| SS316LPFNRS10065 | 108×67 | 178 | 75 | 50 | 2.0 | 2.0 | 0.905 | 12 |
| SS316LPFNRS10080 | 108×76 | 178 | 75 | 51 | 2.0 | 2.0 | 0.942 | 12 |