

NORIKA STAINLESS STEEL 316L PRESS FIT FITTINGS (M- PROFILE)





TEST CERTIFICATE

POTABLE WATER FITTINGS SCHEME

Certificate Number : TC-J0133
Issue No: 04

This Certificate is awarded to the following product(s) which has / have complied with the requirements of the listed standard(s) in accordance with Stipulation of Standards and Requirements for Water Fittings for Use in Potable Water Service Installations.

Client : **Liang Chew Hardware Pte Ltd**
 133 Kitchener Road
 Singapore 208517

Product : Stainless Steel 316L Press Fit Fittings

Brand / Model : Norika / SS316LPFN

Detail : Sizes (mm): 15, 22, 28, 35, 42, 54, 67, 80 & 100

Test Standard(s) : BS EN 1254-2: 1998, AS/NZS 4020: 2005, ASTM E 1086: 2014, SS 375: 2015, SS 270: 2015

Test Report(s) : 2323069-LCH, 1920519/02-OYC, 2221990-OYC, 1920519/04-CPC, FB8500287176, 1920519/03-CPC

A sample of the product submitted was tested and found to comply with the test requirements of the above standard(s).

Date of Original Issue : 13 January 2020

Date of Last Revision : 26 February 2024

Date of Expiry : 12 January 2026

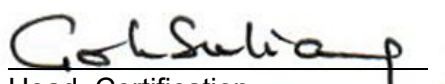
 Head, Certification
 Singapore Test Lab Pte Ltd

This Certificate is part of a full report and should be read in conjunction with it. This Certificate remains the property of Singapore Test Lab Pte Ltd and shall be returned upon request. The use of this Certificate is subjected to the Terms and Conditions of Singapore Test Lab Pte Ltd. The manufacturer is solely responsible for the compliance of any product that has the same designation as the product type tested.



Singapore Test Lab Pte Ltd certifies according to ISO / IEC 17065

Singapore Test Lab Pte Ltd · 10B Enterprise Road · Singapore 629828 Tel: 6353 6393 Fax: 6353 6395



STAINLESS STEEL 316L PRESS FIT FITTINGS (M PROFILE)

COMPLY WITH BSEN1254-2: 1998



45° ELBOW

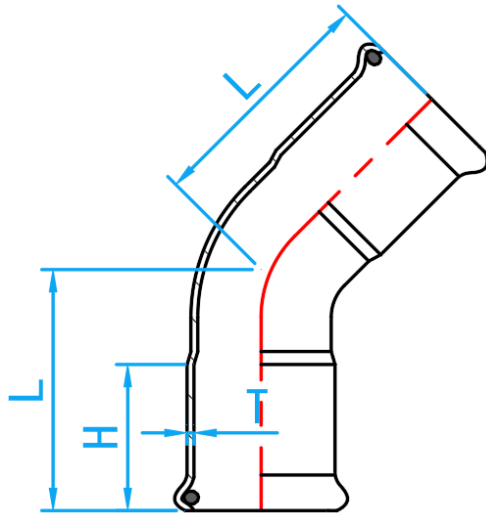

CROSS SECTIONAL VIEW

DIMENSIONS

| SKU | SIZE (mm) | L (mm) | H (mm) | T (mm) | WEIGHT (kg) | PCS/CTN |
|-----------------|--------------|-----------|-----------|-----------|----------------|---------|
| SS316LPFNE45015 | 15 | 31 | 20 | 1.5 | 0.037 | 400 |
| SS316LPFNE45020 | 22 | 33 | 21 | 1.5 | 0.065 | 160 |
| SS316LPFNE45025 | 28 | 40 | 23 | 1.5 | 0.090 | 120 |
| SS316LPFNE45035 | 35 | 45 | 26 | 1.5 | 0.125 | 140 |
| SS316LPFNE45042 | 42 | 54 | 31 | 1.5 | 0.217 | 80 |
| SS316LPFNE45050 | 54 | 65 | 36 | 1.5 | 0.268 | 48 |
| SS316LPFNE45065 | 65 | 93 | 50 | 1.8 | 0.604 | 18 |
| SS316LPFNE45080 | 76 | 98 | 51 | 2.0 | 0.812 | 12 |
| SS316LPFNE45100 | 108 | 133 | 75 | 2.0 | 1.615 | 4 |

STAINLESS STEEL 316L PRESS FIT FITTINGS (M PROFILE)

COMPLY WITH BSEN1254-2: 1998



MXF 45° ELBOW

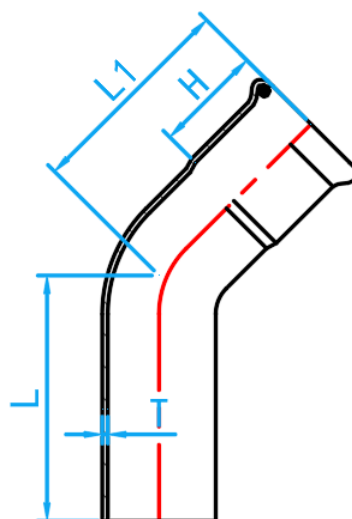

CROSS SECTIONAL VIEW

DIMENSIONS

| SKU | SIZE (mm) | L (mm) | L1 (mm) | H (mm) | T (mm) | WEIGHT (kg) | PCS/CTN |
|-------------------|--------------|-----------|------------|-----------|-----------|----------------|---------|
| SS316LPFNE45015MF | 15 | 35 | 31 | 20 | 1.5 | 0.036 | 360 |
| SS316LPFNE45020MF | 22 | 36 | 37 | 21 | 1.5 | 0.060 | 200 |
| SS316LPFNE45025MF | 28 | 42 | 38 | 23 | 1.5 | 0.109 | 120 |
| SS316LPFNE45035MF | 35 | 53 | 45 | 26 | 1.5 | 0.148 | 150 |
| SS316LPFNE45042MF | 42 | 61 | 54 | 31 | 1.5 | 0.180 | 60 |
| SS316LPFNE45050MF | 54 | 73 | 63 | 36 | 1.5 | 0.270 | 48 |
| SS316LPFNE45065MF | 67 | 106 | 93 | 50 | 1.8 | 0.600 | 15 |
| SS316LPFNE45080MF | 76 | 120 | 97 | 51 | 2.0 | 0.837 | 12 |
| SS316LPFNE45100MF | 108 | 164 | 130 | 75 | 2.0 | 1.600 | 4 |

STAINLESS STEEL 316L PRESS FIT FITTINGS (M PROFILE)

COMPLY WITH BSEN1254-2: 1998



MXF 90° ELBOW

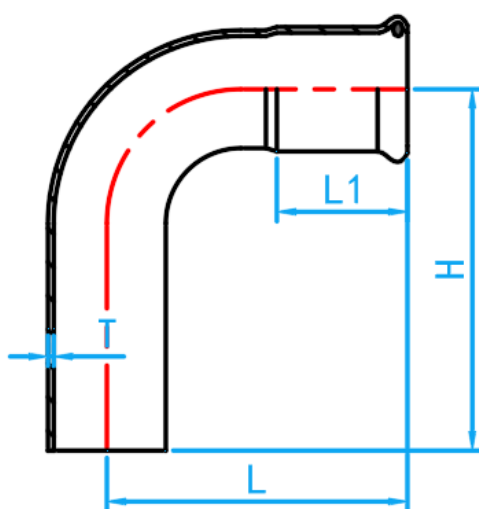

CROSS SECTIONAL VIEW

DIMENSIONS

| SKU | SIZE (mm) | L (mm) | L1 (mm) | H (mm) | T (mm) | WEIGHT (kg) | PCS/CTN |
|-------------------|--------------|-----------|------------|-----------|-----------|----------------|---------|
| SS316LPFNE90015MF | 15 | 42 | 20 | 44 | 1.5 | 0.042 | 360 |
| SS316LPFNE90020MF | 22 | 51 | 21 | 55 | 1.5 | 0.093 | 150 |
| SS316LPFNE90025MF | 28 | 60 | 23 | 68 | 1.5 | 0.131 | 160 |
| SS316LPFNE90035MF | 35 | 72 | 26 | 89 | 1.5 | 0.212 | 100 |
| SS316LPFNE90042MF | 42 | 85 | 31 | 95 | 1.5 | 0.268 | 60 |
| SS316LPFNE90050MF | 54 | 105 | 36 | 113 | 1.5 | 0.415 | 30 |
| SS316LPFNE90065MF | 67 | 140 | 50 | 150 | 1.8 | 0.800 | 15 |
| SS316LPFNE90080MF | 76 | 150 | 51 | 182 | 2.0 | 1.026 | 12 |
| SS316LPFNE90100MF | 108 | 221 | 75 | 238 | 2.0 | 2.206 | 4 |

STAINLESS STEEL 316L PRESS FIT FITTINGS (M PROFILE)

COMPLY WITH BSEN1254-2: 1998



90° ELBOW

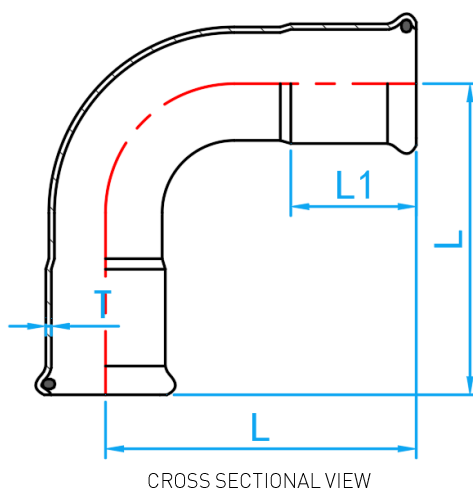

DIMENSIONS

| SKU | SIZE (mm) | L (mm) | L1 (mm) | T (mm) | WEIGHT (kg) | PCS/CTN |
|-----------------|--------------|-----------|------------|-----------|----------------|---------|
| SS316LPFNE90015 | 15 | 42 | 20 | 1.5 | 0.045 | 300 |
| SS316LPFNE90020 | 22 | 51 | 21 | 1.5 | 0.077 | 150 |
| SS316LPFNE90025 | 28 | 60 | 23 | 1.5 | 0.124 | 150 |
| SS316LPFNE90035 | 35 | 72 | 26 | 1.5 | 0.165 | 100 |
| SS316LPFNE90042 | 42 | 85 | 31 | 1.5 | 0.239 | 60 |
| SS316LPFNE90050 | 54 | 105 | 36 | 1.5 | 0.375 | 32 |
| SS316LPFNE90065 | 67 | 143 | 50 | 1.8 | 0.825 | 13 |
| SS316LPFNE90080 | 76 | 150 | 51 | 2.0 | 0.990 | 12 |
| SS316LPFNE90100 | 108 | 221 | 75 | 2.0 | 2.110 | 4 |

STAINLESS STEEL 316L PRESS FIT FITTINGS (M PROFILE)

COMPLY WITH BSEN1254-2: 1998



FI 90° ELBOW

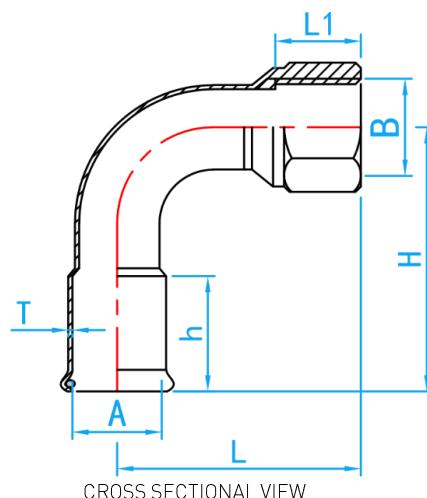

DIMENSIONS

| SKU | A×B (mm × inch) | L (mm) | H (mm) | h (mm) | L1 (mm) | T (mm) | WEIGHT (kg) | PCS/CTN |
|-----------------|--------------------|-----------|-----------|-----------|------------|-----------|----------------|---------|
| SS316LFIE01515 | 15×1/2"BSP | 43 | 43 | 20 | 15.5 | 1.5 | 0.060 | 300 |
| SS316LFIE02015 | 22×1/2"BSP | 43 | 50 | 21 | 15.5 | 1.5 | 0.078 | 160 |
| SS316LFIE02020 | 22×3/4"BSP | 48 | 50 | 21 | 16.0 | 1.5 | 0.090 | 160 |
| SS316LFIE02515* | 28×1/2"BSP | 68 | 60 | 23 | 15.5 | 1.5 | 0.115 | 160 |
| SS316LFIE02520* | 28×3/4"BSP | 55 | 60 | 23 | 16.0 | 1.5 | 0.128 | 80 |
| SS316LFIE02525 | 28×1"BSP | 62 | 60 | 23 | 20.0 | 1.5 | 0.146 | 70 |
| SS316LFIE03515 | 35×1/2"BSP | 76 | 72 | 26 | 15.5 | 1.5 | 0.165 | 60 |
| SS316LFIE03520* | 35×3/4"BSP | 76 | 72 | 26 | 16.0 | 1.5 | 0.170 | 60 |
| SS316LFIE03525 | 35×1"BSP | 65 | 72 | 26 | 20.0 | 1.5 | 0.195 | 60 |
| SS316LFIE03525L | 35×1"BSP | 80 | 90 | 26 | 20.0 | 1.5 | 0.230 | 40 |
| SS316LFIE03535 | 35×1 1/4"BSP | 68 | 72 | 26 | 22.0 | 1.5 | 0.235 | 80 |
| SS316LFIE04215* | 42×1/2"BSP | 86 | 85 | 31 | 15.5 | 1.5 | 0.165 | 30 |
| SS316LFIE04220* | 42×3/4"BSP | 83 | 85 | 31 | 16.0 | 1.5 | 0.233 | 30 |
| SS316LFIE04225* | 42×1"BSP | 90 | 85 | 31 | 20.0 | 1.5 | 0.260 | 30 |
| SS316LFIE04235* | 42×1 1/4"BSP | 98 | 85 | 31 | 22.0 | 1.5 | 0.278 | 30 |
| SS316LFIE04242 | 42×1 1/2"BSP | 80 | 85 | 31 | 25.0 | 1.5 | 0.300 | 30 |
| SS316LFIE05015* | 54×1/2"BSP | 97 | 105 | 35 | 15.5 | 1.5 | 0.337 | 21 |
| SS316LFIE05020* | 54×3/4"BSP | 100 | 105 | 35 | 20.0 | 1.5 | 0.345 | 25 |
| SS316LFIE05025* | 54×1"BSP | 102 | 105 | 35 | 22.0 | 1.5 | 0.378 | 25 |
| SS316LFIE05035 | 54×1 1/4"BSP | 106 | 105 | 35 | 24.0 | 1.5 | 0.403 | 25 |
| SS316LFIE05042* | 54×1 1/2"BSP | 100 | 105 | 35 | 25.0 | 1.5 | 0.396 | 25 |
| SS316LFIE05050 | 54×2"BSP | 93 | 105 | 36 | 25.0 | 1.5 | 0.460 | 30 |
| SS316LFIE06565 | 67×2 1/2"BSP | 133 | 143 | 50 | 28.0 | 1.8 | 0.970 | 15 |

*This item requires special ordering. Please consult with a salesperson for the estimated lead time.

STAINLESS STEEL 316L PRESS FIT FITTINGS (M PROFILE)

COMPLY WITH BSEN1254-2: 1998



MI 90° ELBOW

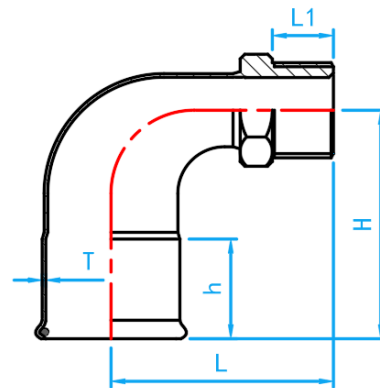

CROSS SECTIONAL VIEW

DIMENSIONS

| SKU | SIZE (mm × inch) | H (mm) | L (mm) | h (mm) | L1 (mm) | T (mm) | WEIGHT (kg) | PCS/CTN |
|--------------------|---------------------|-----------|-----------|-----------|------------|-----------|----------------|---------|
| SS316LPFNMIE01515 | 15×1/2"BSPT | 43.0 | 42.0 | 20 | 15 | 1.5 | 0.060 | 300 |
| SS316LPFNMIE02015 | 22×1/2"BSPT | 50.0 | 46.0 | 21 | 15 | 1.5 | 0.080 | 200 |
| SS316LPFNMIE02020 | 22×3/4"BSPT | 50.0 | 50.0 | 21 | 16 | 1.5 | 0.092 | 160 |
| SS316LPFNMIE02515 | 28×1/2"BSPT | 60.0 | 68.0 | 23 | 19 | 1.5 | 0.120 | 100 |
| SS316LPFNMIE02525 | 28×1"BSPT | 60.0 | 68.0 | 23 | 19 | 1.5 | 0.145 | 70 |
| SS316LPFNMIE03515* | 35×1/2"BSPT | 72.0 | 78.0 | 26 | 15 | 1.5 | 0.162 | 50 |
| SS316LPFNMIE03525* | 35×1"BSPT | 72.0 | 73.0 | 26 | 19 | 1.5 | 0.180 | 50 |
| SS316LPFNMIE03535 | 35×11/4"BSPT | 72.0 | 74.0 | 26 | 21 | 1.5 | 0.225 | 55 |
| SS316LPFNMIE04225* | 42×1"BSPT | 85.0 | 93.0 | 26 | 19 | 1.5 | 0.255 | 50 |
| SS316LPFNMIE04242 | 42×11/2"BSPT | 85.0 | 84.0 | 31 | 21 | 1.5 | 0.300 | 33 |
| SS316LPFNMIE05025 | 54×1"BSPT | 105.0 | 112.0 | 36 | 19 | 1.5 | 0.365 | 50 |
| SS316LPFNMIE05050 | 54×2"BSPT | 105.0 | 105.0 | 36 | 26 | 1.5 | 0.485 | 21 |
| SS316LPFNMIE06565 | 67×21/2"BSPT | 143.0 | 131.5 | 50 | 26 | 1.8 | 0.970 | 12 |

*This item requires special ordering. Please consult with a salesperson for the estimated lead time.

STAINLESS STEEL 316L PRESSFIT FITTINGS (M PROFILE)

COMPLY WITH BSEN1254-2: 1998



REDUCER 90° ELBOW

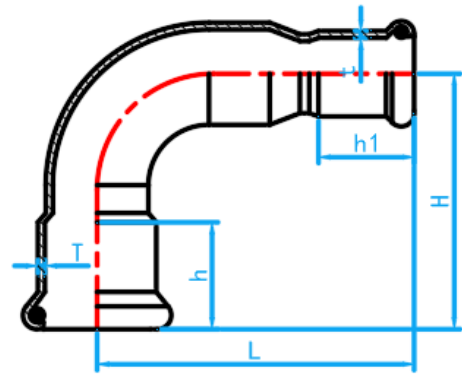

CROSS SECTIONAL VIEW

DIMENSIONS

| SKU | SIZE (mm) | H (mm) | L (mm) | h (mm) | h1 (mm) | T (mm) | t (mm) | WEIGHT (kg) | PCS/CTN |
|---------------------|-----------|--------|--------|--------|---------|--------|--------|-------------|---------|
| SS316LPFNRE9002015 | 22x15 | 52 | 43 | 21 | 20 | 1.5 | 1.5 | 0.065 | 160 |
| SS316LPFNRE9002515 | 28x15 | 60 | 43 | 23 | 20 | 1.5 | 1.5 | 0.075 | 140 |
| SS316LPFNRE9002520 | 28x22 | 62 | 50 | 23 | 21 | 1.5 | 1.5 | 0.095 | 160 |
| SS316LPFNRE9003515 | 35x15 | 63 | 43 | 26 | 20 | 1.5 | 1.5 | 0.100 | 100 |
| SS316LPFNRE9003520 | 35x22 | 70 | 50 | 26 | 21 | 1.5 | 1.5 | 0.115 | 80 |
| SS316LPFNRE9003525 | 35x28 | 76 | 60 | 26 | 23 | 1.5 | 1.5 | 0.135 | 70 |
| SS316LPFNRE9004215 | 42x15 | 72 | 43 | 31 | 20 | 1.5 | 1.5 | 0.125 | 60 |
| SS316LPFNRE9004220 | 42x22 | 73 | 50 | 31 | 21 | 1.5 | 1.5 | 0.145 | 60 |
| SS316LPFNRE9004225 | 42x28 | 84 | 60 | 31 | 23 | 1.5 | 1.5 | 0.165 | 60 |
| SS316LPFNRE9004235* | 42x35 | 87 | 72 | 31 | 26 | 1.5 | 1.5 | 0.200 | 60 |
| SS316LPFNRE9005015 | 54x15 | 82 | 43 | 36 | 20 | 1.5 | 1.5 | 0.170 | 56 |
| SS316LPFNRE9005020 | 54x22 | 87 | 50 | 36 | 21 | 1.5 | 1.5 | 0.186 | 56 |
| SS316LPFNRE9005025 | 54x28 | 93 | 60 | 36 | 23 | 1.5 | 1.5 | 0.215 | 56 |
| SS316LPFNRE9005035 | 54x35 | 97 | 72 | 36 | 26 | 1.5 | 1.5 | 0.245 | 30 |
| SS316LPFNRE9005042 | 54x42 | 105 | 85 | 36 | 31 | 1.5 | 1.5 | 0.298 | 30 |
| SS316LPFNRE9006525 | 67x28 | 115 | 60 | 50 | 23 | 1.8 | 1.5 | 0.354 | 15 |
| SS316LPFNRE9006535 | 67x35 | 118 | 72 | 50 | 26 | 1.8 | 1.5 | 0.394 | 15 |
| SS316LPFNRE9006542 | 67x42 | 84 | 85 | 50 | 31 | 1.8 | 1.5 | 0.428 | 15 |
| SS316LPFNRE9006550 | 67x54 | 108 | 105 | 50 | 36 | 1.8 | 1.5 | 0.523 | 15 |

*This item requires special ordering. Please consult with a salesperson for the estimated lead time.

STAINLESS STEEL 316L PRESS FIT FITTINGS (M PROFILE)

COMPLY WITH BSEN1254-2: 1998

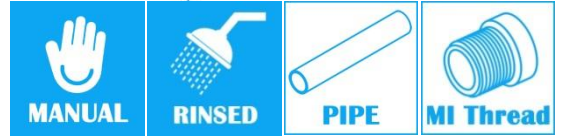

WALL PLATE ELBOW

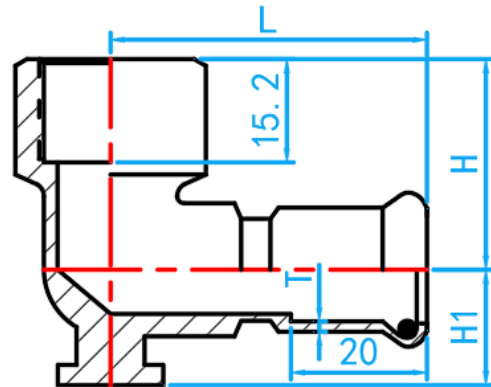
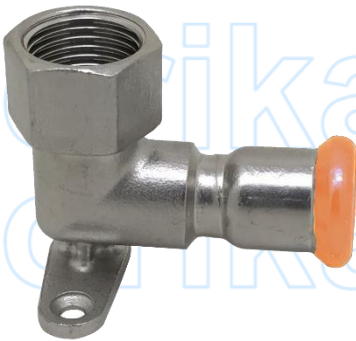

CROSS SECTIONAL VIEW

DIMENSIONS

| SKU | SIZE (mm x inch) | L (mm) | H (mm) | H1 (mm) | T (mm) | WEIGHT (kg) | PCS/CTN |
|----------------|---------------------|-----------|-----------|------------|-----------|----------------|---------|
| SS316LPFNFE015 | 15×1/2" BSP | 48 | 26 | 15 | 1.5 | 0.089 | 150 |

STAINLESS STEEL 316L PRESS FIT FITTINGS (M PROFILE)

COMPLY WITH BSEN1254-2: 1998

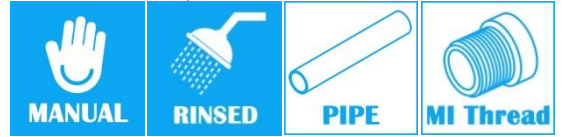

Wall Plate FI Tee

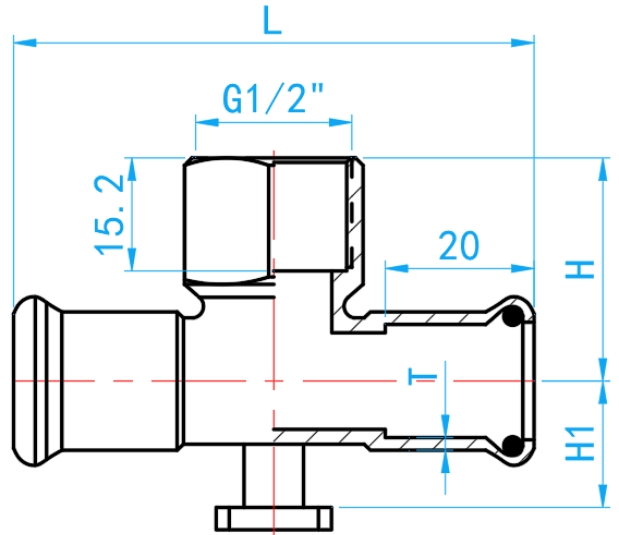

CROSS SECTIONAL VIEW

DIMENSIONS

| SKU | SIZE (mm x mm x inch) | L (mm) | H (mm) | H1 (mm) | T (mm) | WEIGHT (kg) | PCS/CTN |
|----------------|--------------------------|-----------|-----------|------------|-----------|----------------|---------|
| SS316LPFNFT015 | 15×15×1/2" BSP | 70 | 32 | 20 | 1.5 | 0.093 | 140 |

STAINLESS STEEL 316L PRESS FIT FITTINGS (M PROFILE)

COMPLY WITH BSEN1254-2: 1998



DOUBLE ELBOW WALL MOUNTED PLATE

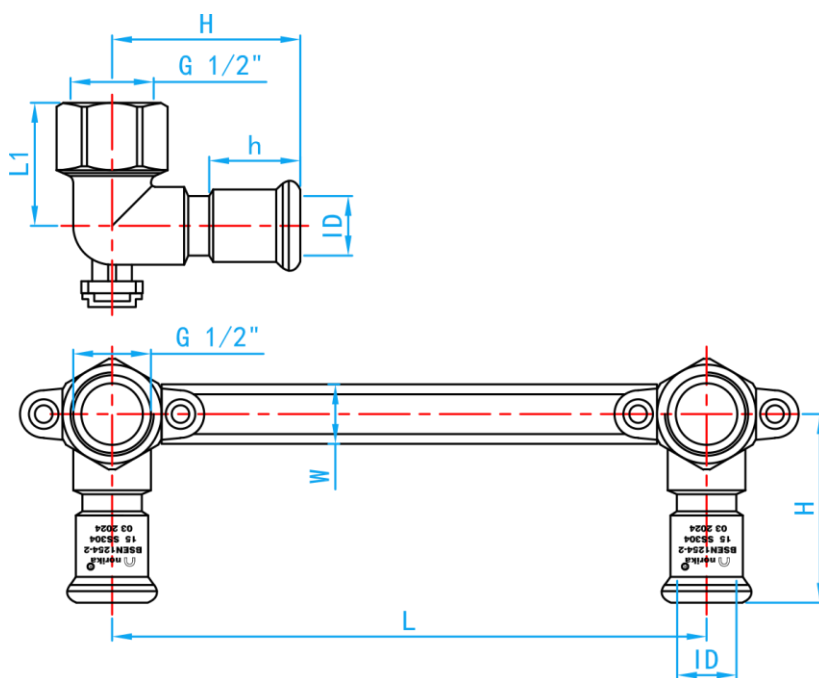

SIDE VIEW

DIMENSIONS

| SKU | SIZE ID×G (mm x inch) | L (mm) | L1 (mm) | H (mm) | h (mm) | W (mm) | WEIGHT (kg) | PCS/CTN |
|------------------|-----------------------------|-----------|------------|-----------|-----------|-----------|----------------|---------|
| SS316LPFNFE015S* | 15×1/2" BSP | 150 | 31 | 47.5 | 23 | 15 | 0.200 | 40 |

*This item requires special ordering. Please consult with a salesperson for the estimated lead time.

STAINLESS STEEL 316L PRESS FIT FITTINGS (M PROFILE)

COMPLY WITH BSEN1254-2: 1998



EQUAL SOCKET

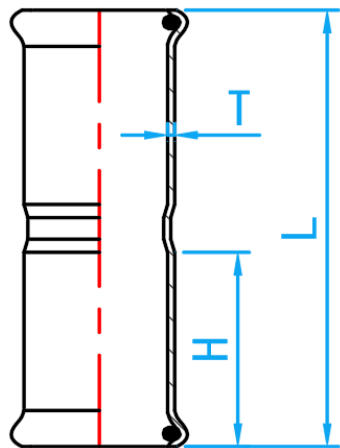

CROSS SECTIONAL VIEW

DIMENSIONS

| SKU | SIZE (mm) | L (mm) | H (mm) | T (mm) | WEIGHT (kg) | PCS/CTN |
|----------------|--------------|-----------|-----------|-----------|----------------|---------|
| SS316LPFNES015 | 15 | 53 | 20 | 1.5 | 0.036 | 420 |
| SS316LPFNES020 | 22 | 55 | 21 | 1.5 | 0.056 | 200 |
| SS316LPFNES025 | 28 | 59 | 23 | 1.5 | 0.074 | 140 |
| SS316LPFNES035 | 35 | 65 | 26 | 1.5 | 0.099 | 160 |
| SS316LPFNES042 | 42 | 76 | 31 | 1.5 | 0.144 | 120 |
| SS316LPFNES050 | 54 | 88 | 36 | 1.5 | 0.209 | 74 |
| SS316LPFNES065 | 67 | 124 | 50 | 1.8 | 0.416 | 33 |
| SS316LPFNES080 | 76 | 134 | 51 | 2.0 | 0.520 | 20 |
| SS316LPFNES100 | 108 | 182 | 75 | 2.0 | 1.130 | 6 |

STAINLESS STEEL 316L PRESS FIT FITTINGS (M PROFILE)

COMPLY WITH BSEN1254-2: 1998



LONG EQUAL SOCKET

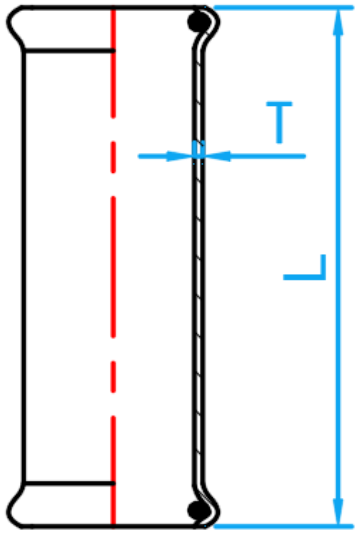

CROSS SECTIONAL VIEW

DIMENSIONS

| SKU | SIZE (mm) | L (mm) | T (mm) | WEIGHT (kg) | PCS/CTN |
|-----------------|--------------|-----------|-----------|----------------|---------|
| SS316LPFNES015L | 15 | 80 | 1.5 | 0.053 | 250 |
| SS316LPFNES020L | 22 | 85 | 1.5 | 0.086 | 120 |
| SS316LPFNES025L | 28 | 95 | 1.5 | 0.120 | 100 |
| SS316LPFNES035L | 35 | 105 | 1.5 | 0.150 | 60 |
| SS316LPFNES042L | 42 | 120 | 1.5 | 0.250 | 70 |
| S316SLPFNES050L | 54 | 135 | 1.5 | 0.290 | 40 |
| SS316LPFNES065L | 67 | 200 | 1.8 | 0.690 | 20 |
| SS316LPFNES080L | 76 | 225 | 2.0 | 0.900 | 15 |
| SS316PFNES0100L | 108 | 315 | 2.0 | 1.860 | 4 |

STAINLESS STEEL 316L PRESS FIT FITTINGS (M PROFILE)

COMPLY WITH BSEN1254-2: 1998



MXF REDUCER

DIMENSIONS

| SKU | SIZE (mm) | H (mm) | h (mm) | T (mm) | T1 (mm) | WEIGHT (kg) | PCS/ CTN |
|---------------------|--------------|-----------|-----------|-----------|------------|----------------|-------------|
| SS316LPFNRS02015MF | 22×15 | 68 | 20 | 1.5 | 1.5 | 0.048 | 300 |
| SS316LPFNRS02515MF | 28×15 | 73 | 20 | 1.5 | 1.5 | 0.059 | 300 |
| SS316LPFNRS02520MF | 28×22 | 71 | 21 | 1.5 | 1.5 | 0.065 | 250 |
| SS316LPFNRS03515MF | 35×15 | 81 | 20 | 1.5 | 1.5 | 0.080 | 160 |
| SS316LPFNRS03520MF | 35×22 | 80 | 21 | 1.5 | 1.5 | 0.091 | 100 |
| SS316LPFNRS03525MF | 35×28 | 80 | 23 | 1.5 | 1.5 | 0.089 | 80 |
| SS316LPFNRS04215MF | 42×15 | 90 | 20 | 1.5 | 1.5 | 0.110 | 80 |
| SS316LPFNRS04220MF | 42×22 | 87 | 21 | 1.5 | 1.5 | 0.116 | 100 |
| SS316LPFNRS04225MF | 42×28 | 87 | 23 | 1.5 | 1.5 | 0.124 | 110 |
| SS316LPFNRS04235MF | 42×35 | 88 | 26 | 1.5 | 1.5 | 0.125 | 60 |
| SS316LPFNRS05015MF | 54×15 | 105 | 20 | 1.5 | 1.5 | 0.162 | 77 |
| SS316LPFNRS05020MF | 54×22 | 104 | 21 | 1.5 | 1.5 | 0.170 | 77 |
| SS316LPFNRS05025MF | 54×28 | 102 | 23 | 1.5 | 1.5 | 0.175 | 100 |
| SS316LPFNRS05035MF | 54×35 | 104 | 26 | 1.5 | 1.5 | 0.185 | 90 |
| SS316LPFNRS05042MF | 54×42 | 103 | 31 | 1.5 | 1.5 | 0.195 | 80 |
| SS316LPFNRS06525MF | 67×28 | 127 | 23 | 1.8 | 1.5 | 0.320 | 40 |
| SS316LPFNRS06535MF | 67×35 | 128 | 26 | 1.8 | 1.5 | 0.316 | 40 |
| SS316LPFNRS06542MF | 67×42 | 130 | 31 | 1.8 | 1.5 | 0.330 | 40 |
| SS316LPFNRS06550MF | 67×54 | 132 | 36 | 1.8 | 1.5 | 0.350 | 40 |
| SS316LPFNRS08025MF | 76×28 | 140 | 23 | 2.0 | 1.5 | 0.425 | 20 |
| SS316LPFNRS08035MF | 76×35 | 141 | 26 | 2.0 | 1.5 | 0.435 | 20 |
| SS316LPFNRS08042MF* | 76×42 | 145 | 31 | 2.0 | 1.5 | 0.470 | 20 |
| SS316LPFNRS08050MF | 76×54 | 147 | 36 | 2.0 | 1.5 | 0.470 | 30 |
| SS316LPFNRS08065MF | 76×67 | 162 | 50 | 2.0 | 1.8 | 0.560 | 21 |
| SS316LPFNRS10042MF* | 108×42 | 180 | 31 | 2.0 | 1.5 | 0.810 | 12 |
| SS316LPFNRS10050MF | 108×54 | 182 | 36 | 2.0 | 1.5 | 0.830 | 10 |
| SS316LPFNRS10065MF | 108×67 | 195 | 50 | 2.0 | 1.8 | 0.920 | 9 |
| SS316LPFNRS10080MF | 108×76 | 198 | 51 | 2.0 | 2.0 | 0.960 | 9 |

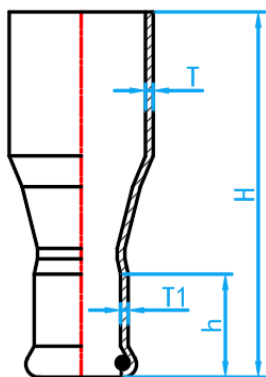

CROSS SECTIONAL VIEW

*This item requires special ordering. Please consult with a salesperson for the estimated lead time.

STAINLESS STEEL 316L PRESS FIT FITTINGS (M PROFILE)

COMPLY WITH BSEN1254-2: 1998



REDUCEING SOCKET

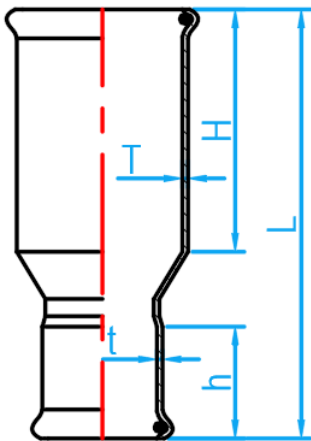

CROSS SECTIONAL VIEW

DIMENSIONS

| SKU | SIZE (mm) | L (mm) | H (mm) | h (mm) | T (mm) | t (mm) | WEIGHT (kg) | PCS/ CTN |
|------------------|--------------|-----------|-----------|-----------|-----------|-----------|----------------|-------------|
| SS316LPFNRS02015 | 22×15 | 63 | 21 | 20 | 1.5 | 1.5 | 0.054 | 200 |
| SS316LPFNRS02515 | 28×15 | 68 | 23 | 20 | 1.5 | 1.5 | 0.068 | 160 |
| SS316LPFNRS02520 | 28×22 | 65 | 23 | 21 | 1.5 | 1.5 | 0.075 | 130 |
| SS316LPFNRS03515 | 35×15 | 73 | 26 | 20 | 1.5 | 1.5 | 0.087 | 160 |
| SS316LPFNRS03520 | 35×22 | 73 | 26 | 21 | 1.5 | 1.5 | 0.083 | 120 |
| SS316LPFNRS03525 | 35×28 | 74 | 26 | 23 | 1.5 | 1.5 | 0.097 | 80 |
| SS316LPFNRS04215 | 42×15 | 83 | 31 | 20 | 1.5 | 1.5 | 0.110 | 120 |
| SS316LPFNRS04220 | 42×22 | 80 | 31 | 21 | 1.5 | 1.5 | 0.122 | 130 |
| SS316LPFNRS04225 | 42×28 | 80 | 31 | 23 | 1.5 | 1.5 | 0.125 | 100 |
| SS316LPFNRS04235 | 42×35 | 82 | 31 | 26 | 1.5 | 1.5 | 0.133 | 70 |
| SS316LPFNRS05015 | 54×15 | 93 | 36 | 20 | 1.5 | 1.5 | 0.166 | 70 |
| SS316LPFNRS05020 | 54×22 | 92 | 36 | 21 | 1.5 | 1.5 | 0.162 | 70 |
| SS316LPFNRS05025 | 54×28 | 93 | 36 | 23 | 1.5 | 1.5 | 0.175 | 100 |
| SS316LPFNRS05035 | 54×35 | 94 | 36 | 26 | 1.5 | 1.5 | 0.180 | 70 |
| SS316LPFNRS05042 | 54×42 | 94 | 36 | 31 | 1.5 | 1.5 | 0.207 | 70 |
| SS316LPFNRS06515 | 67×15 | 114 | 50 | 20 | 1.8 | 1.5 | 0.300 | 25 |
| SS316LPFNRS06520 | 67×22 | 114 | 50 | 21 | 1.8 | 1.5 | 0.310 | 50 |
| SS316LPFNRS06525 | 67×28 | 116 | 50 | 23 | 1.8 | 1.5 | 0.300 | 25 |
| SS316LPFNRS06535 | 67×35 | 115 | 50 | 26 | 1.8 | 1.5 | 0.310 | 25 |
| SS316LPFNRS06542 | 67×42 | 117 | 50 | 31 | 1.8 | 1.5 | 0.320 | 25 |
| SS316LPFNRS06550 | 67×54 | 119 | 50 | 36 | 1.8 | 1.5 | 0.347 | 36 |
| SS316LPFNRS08025 | 76×28 | 120 | 51 | 23 | 2.0 | 1.5 | 0.380 | 20 |
| SS316LPFNRS08035 | 76×35 | 123 | 51 | 26 | 2.0 | 1.5 | 0.400 | 20 |
| SS316LPFNRS08042 | 76×42 | 128 | 51 | 31 | 2.0 | 1.5 | 0.435 | 20 |
| SS316LPFNRS08050 | 76×54 | 129 | 51 | 36 | 2.0 | 1.5 | 0.430 | 36 |
| SS316LPFNRS08065 | 76×67 | 141 | 51 | 50 | 2.0 | 1.8 | 0.520 | 20 |
| SS316LPFNRS10042 | 108×42 | 158 | 75 | 31 | 2.0 | 1.5 | 0.790 | 12 |
| SS316LPFNRS10050 | 108×54 | 162 | 75 | 36 | 2.0 | 1.5 | 0.810 | 12 |
| SS316LPFNRS10065 | 108×67 | 180 | 75 | 50 | 2.0 | 1.8 | 0.905 | 12 |
| SS316LPFNRS10080 | 108×76 | 180 | 75 | 51 | 2.0 | 2.0 | 0.942 | 12 |

STAINLESS STEEL 316L PRESS FIT FITTINGS (M PROFILE)

COMPLY WITH BSEN1254-2: 1998



MI SOCKET

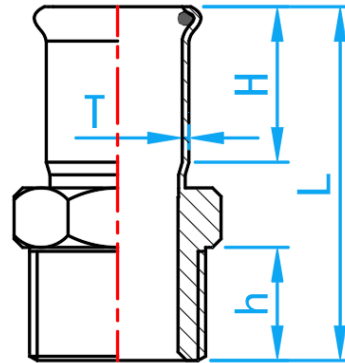

CROSS SECTIONAL VIEW

DIMENSIONS

| SKU | SIZE (mm x inch) | L (mm) | H (mm) | h (mm) | T (mm) | WEIGHT (kg) | PCS/CTN |
|-----------------|------------------|--------|--------|--------|--------|-------------|---------|
| SS316LMIA01515 | 15×1/2" BSPT | 51.0 | 20 | 15 | 1.5 | 0.044 | 420 |
| SS316LMIA02015 | 22×1/2" BSPT | 53.0 | 20 | 15 | 1.5 | 0.060 | 170 |
| SS316LMIA02020 | 22×3/4" BSPT | 55.0 | 21 | 16 | 1.5 | 0.065 | 200 |
| SS316LMIA02025* | 22×1" BSPT | 70.0 | 24 | 16 | 1.5 | 0.105 | 130 |
| SS316LMIA02515* | 28×1/2" BSPT | 66.5 | 24 | 14 | 1.5 | 0.075 | 130 |
| SS316LMIA02520* | 28×3/4" BSPT | 58.0 | 24 | 16 | 1.5 | 0.082 | 130 |
| SS316LMIA02525 | 28×1" BSPT | 62.0 | 33 | 19 | 1.5 | 0.105 | 130 |
| SS316LMIA03515* | 35×1/2" BSPT | 76.0 | 26 | 15 | 1.5 | 0.095 | 80 |
| SS316LMIA03520* | 35×3/4" BSPT | 75.0 | 26 | 15 | 1.5 | 0.100 | 80 |
| SS316LMIA03525 | 35×1" BSPT | 67.0 | 26 | 21 | 1.5 | 0.120 | 80 |
| SS316LMIA03535 | 35×1 1/4" BSPT | 70.0 | 26 | 21 | 1.5 | 0.160 | 80 |
| SS316LMIA03542* | 35×1 1/2" BSPT | 82.0 | 28 | 22 | 1.5 | 0.165 | 66 |
| SS316LMIA03550* | 35×2" BSPT | 92.0 | 26 | 26 | 1.5 | 0.300 | 38 |
| SS316LMIA04215* | 42×1/2" BSPT | 81.0 | 31 | 14 | 1.5 | 0.120 | 50 |
| SS316LMIA04220* | 42×3/4" BSPT | 82.0 | 31 | 16 | 1.5 | 0.132 | 50 |
| SS316LMIA04225* | 42×1" BSPT | 84.0 | 24 | 22 | 1.5 | 0.150 | 50 |
| SS316LMIA04235* | 42×1 1/4" BSPT | 75.0 | 31 | 21 | 1.5 | 0.180 | 50 |
| SS316LMIA04242 | 42×1 1/2" BSPT | 75.0 | 31 | 21 | 1.5 | 0.195 | 66 |
| SS316LMIA04250* | 42×2" BSPT | 96.0 | 31 | 21 | 1.5 | 0.320 | 50 |
| SS316LMIA05020* | 54×3/4" BSPT | 94.0 | 35 | 16 | 1.5 | 0.178 | 60 |
| SS316LMIA05025* | 54×1" BSPT | 95.0 | 35 | 19 | 1.5 | 0.198 | 50 |
| SS316LMIA05035* | 54×1 1/4" BSPT | 96.0 | 35 | 20 | 1.5 | 0.232 | 38 |
| SS316LMIA05042* | 54×1 1/2" BSPT | 95.0 | 35 | 21 | 1.5 | 0.246 | 38 |
| SS316LMIA05050 | 54×2" BSPT | 88.0 | 36 | 26 | 1.5 | 0.320 | 38 |
| SS316LMIA06565 | 67×2 1/2" BSPT | 110.0 | 50 | 30 | 1.8 | 0.735 | 15 |
| SS316LMIA08065 | 76×2 1/2" BSPT | 115.0 | 55 | 30 | 2.0 | 0.626 | 24 |
| SS316LMIA08080 | 76×3" BSPT | 117.0 | 55 | 32 | 2.0 | 0.825 | 24 |
| SS316LMIA100100 | 108×4" BSPT | 148.0 | 80 | 35 | 2.0 | 1.243 | 10 |

*This item requires special ordering. Please consult with a salesperson for the estimated lead time.

STAINLESS STEEL 316L PRESS FIT FITTINGS (M PROFILE)

COMPLY WITH BSEN1254-2: 1998



FI SOCKET

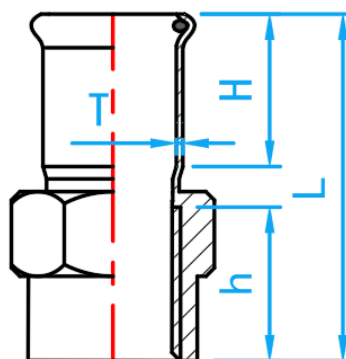

CROSS SECTIONAL VIEW

DIMENSIONS

| SKU | SIZE (mm x inch) | L(mm) | H(mm) | h(mm) | T (mm) | WEIGHT(kg) | PCS/CTN |
|-----------------|------------------|-------|-------|-------|--------|------------|---------|
| SS316LFIA01515 | 15×1/2" BSP | 52 | 20 | 15.5 | 1.5 | 0.050 | 300 |
| SS316LFIA02015* | 22×1/2" BSP | 50 | 20 | 15.5 | 1.5 | 0.055 | 240 |
| SS316LFIA02020 | 22×3/4" BSP | 50 | 21 | 16.0 | 1.5 | 0.070 | 170 |
| SS316LFIA02515* | 28×1/2" BSP | 65 | 23 | 15.5 | 1.5 | 0.075 | 100 |
| SS316LFIA02520* | 28×3/4" BSP | 54 | 23 | 16.0 | 1.5 | 0.080 | 100 |
| SS316LFIA02525 | 28×1" BSP | 57 | 23 | 20.0 | 1.5 | 0.110 | 120 |
| SS316LFIA03515* | 35×1/2" BSP | 72 | 26 | 15.5 | 1.5 | 0.095 | 80 |
| SS316LFIA03520* | 35×3/4" BSP | 70 | 26 | 16.0 | 1.5 | 0.110 | 70 |
| SS316LFIA03525* | 35×1" BSP | 64 | 26 | 20.0 | 1.5 | 0.180 | 80 |
| SS316LFIA03535 | 35×11/4" BSP | 65 | 26 | 22.0 | 1.5 | 0.150 | 75 |
| SS316LFIA03542* | 35×11/2" BSP | 77 | 26 | 25.0 | 1.5 | 0.185 | 60 |
| SS316LFIA04215 | 42×1/2" BSP | 80 | 31 | 15.5 | 1.5 | 0.134 | 120 |
| SS316LFIA04220* | 42×3/4" BSP | 77 | 31 | 16.0 | 1.5 | 0.135 | 120 |
| SS316LFIA04225* | 42×1" BSP | 80 | 31 | 20.0 | 1.5 | 0.155 | 100 |
| SS316LFIA04235* | 42×11/4" BSP | 70 | 31 | 22.0 | 1.5 | 0.170 | 100 |
| SS316LFIA04242 | 42×11/2" BSP | 71 | 31 | 25.0 | 1.5 | 0.200 | 60 |
| SS316LFIA04250* | 42×2" BSP | 90 | 31 | 25.0 | 1.5 | 0.280 | 36 |
| SS316LFIA05015 | 54×1/2" BSP | 90 | 36 | 15.5 | 1.5 | 0.170 | 70 |
| SS316LFIA05020* | 54×3/4" BSP | 90 | 36 | 16.0 | 1.5 | 0.178 | 60 |
| SS316LFIA05025* | 54×1" BSP | 92 | 36 | 20.0 | 1.5 | 0.205 | 60 |
| SS316LFIA05035* | 54×11/4" BSP | 92 | 36 | 22.0 | 1.5 | 0.229 | 60 |
| SS316LFIA05042* | 54×11/2" BSP | 92 | 36 | 25.0 | 1.5 | 0.246 | 36 |
| SS316LFIA05050 | 54×2" BSP | 84 | 35 | 25.0 | 1.5 | 0.285 | 36 |
| SS316LFIA06515 | 67×1/2" BSP | 111 | 50 | 15.5 | 1.8 | 0.310 | 28 |
| SS316LFIA06550* | 67×2" BSP | 115 | 50 | 25.0 | 1.8 | 0.435 | 15 |
| SS316LFIA06565 | 67×21/2" BSP | 115 | 50 | 28.0 | 1.8 | 0.570 | 15 |
| SS316LFIA08015 | 76×1/2" BSP | 120 | 51 | 15.5 | 2.0 | 0.405 | 24 |
| SS316LFIA10015 | 108×1/2" BSP | 153 | 75 | 15.5 | 2.0 | 0.810 | 10 |

*This item requires special ordering. Please consult with a salesperson for the estimated lead time.

STAINLESS STEEL 316L PRESS FIT FITTINGS (M PROFILE)

COMPLY WITH BSEN1254-2: 1998

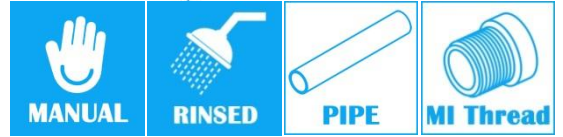

FEMALE JOINT CONNECTOR

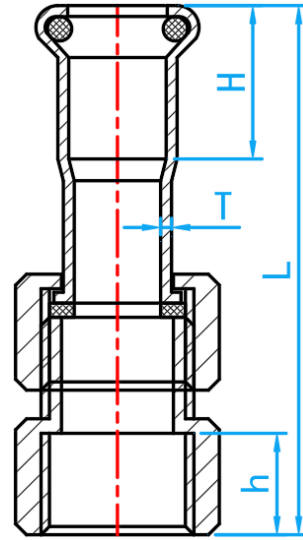

CROSS SECTIONAL VIEW

DIMENSIONS

| SKU | SIZE (mm x inch) | L (mm) | H (mm) | h (mm) | T (mm) | WEIGHT (kg) | PCS/CTN |
|-------------------|---------------------|-----------|-----------|-----------|-----------|----------------|---------|
| SS316LPFNFJC01515 | 15×1/2"BSP | 71 | 20 | 15 | 1.5 | 0.110 | 180 |
| SS316LPFNFJC02020 | 22×3/4"BSP | 75 | 21 | 17 | 1.5 | 0.152 | 150 |
| SS316LPFNFJC02525 | 28×1"BSP | 83 | 23 | 19 | 1.5 | 0.215 | 70 |
| SS316LPFNFJC03535 | 35×1 1/4"BSP | 91 | 26 | 21 | 1.5 | 0.326 | 60 |
| SS316LPFNFJC04242 | 42×1 1/2"BSP | 111 | 31 | 22 | 1.5 | 0.381 | 50 |
| SS316LPFNFJC05050 | 54×2"BSP | 116 | 36 | 27 | 1.5 | 0.634 | 24 |

STAINLESS STEEL 316L PRESS FIT FITTINGS (M PROFILE)

COMPLY WITH BSEN1254-2: 1998



MALE JOINT CONNECTOR

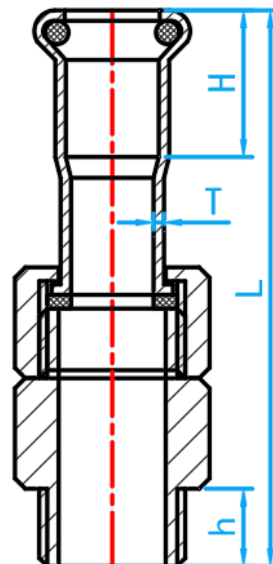

CROSS SECTIONAL VIEW

DIMENSIONS

| SKU | SIZE (mm x inch) | L (mm) | H (mm) | h (mm) | T (mm) | WEIGHT (kg) | PCS/CTN |
|---------------------|---------------------|-----------|-----------|-----------|-----------|----------------|---------|
| SS316LPFNMJC01515 | 15×1/2"BSPT | 88 | 20 | 15 | 1.5 | 0.110 | 180 |
| SS316LPFNMJC02020 | 22×3/4"BSPT | 87 | 21 | 17 | 1.5 | 0.157 | 150 |
| SS316LPFNMJC02525 | 28×1"BSPT | 96 | 23 | 19 | 1.5 | 0.225 | 70 |
| SS316LPFNMJC03525 | 35×1"BSPT | 96 | 26 | 19 | 1.5 | 0.230 | 60 |
| SS316LPFNMJC03535 | 35×11/4"BSPT | 100 | 26 | 21 | 1.5 | 0.302 | 60 |
| SS316LPFNMJC04225 | 42×1"BSPT | 115 | 31 | 19 | 1.5 | 0.275 | 34 |
| SS316LPFNMJC04242 | 42×11/2"BSPT | 107 | 31 | 22 | 1.5 | 0.430 | 34 |
| SS316LPFNMJC05025 | 54×1"BSPT | 125 | 36 | 19 | 1.5 | 0.315 | 24 |
| SS316LPFNMJC05050 | 54×2"BSPT | 130 | 36 | 27 | 1.5 | 0.620 | 24 |
| SS316LPFNMJC06565 | 67×21/2"BSPT | 165 | 50 | 30 | 1.8 | 0.670 | 10 |
| SS316LPFNMJC08080* | 76×3"BSPT | 180 | 51 | 33 | 2.0 | 1.440 | 5 |
| SS316LPFNMJC100100* | 108×4"BSPT | 250 | 75 | 38 | 2.0 | 2.760 | 6 |

*This item requires special ordering. Please consult with a salesperson for the estimated lead time.

STAINLESS STEEL 316L PRESS FIT FITTINGS (M PROFILE)

COMPLY WITH BSEN1254-2: 1998

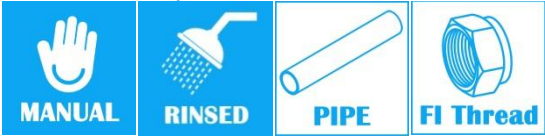

[MI] PIPE

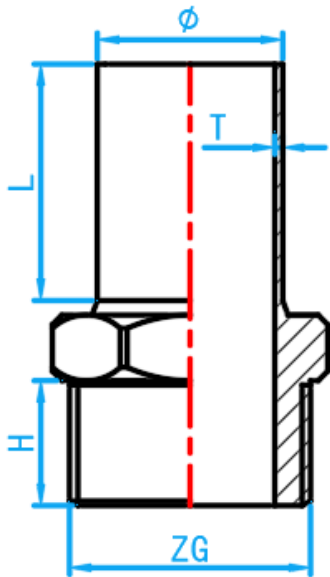

CROSS SECTIONAL VIEW

DIMENSIONS

| SKU | SIZE (mm) | ZG (inch) | Ø (mm) | T (mm) | L (mm) | H (mm) | WEIGHT (kg) | PCS/CTN |
|-------------------|--------------|--------------|-----------|-----------|-----------|-----------|----------------|---------|
| SS316LPFNMIP01515 | 15 | 1/2"BSPT | 15 | 1.5 | 35 | 15 | 0.050 | 500 |
| SS316LPFNMIP02020 | 22 | 3/4"BSPT | 22 | 1.5 | 36 | 16 | 0.070 | 200 |
| SS316LPFNMIP02525 | 28 | 1"BSPT | 28 | 1.5 | 38 | 19 | 0.140 | 150 |
| SS316LPFNMIP03535 | 35 | 1¼"BSPT | 35 | 1.5 | 40 | 21 | 0.150 | 50 |
| SS316LPFNMIP04242 | 42 | 1½"BSPT | 42 | 1.5 | 45 | 21 | 0.190 | 50 |
| SS316LPFNMIP05050 | 54 | 2"BSPT | 54 | 1.5 | 50 | 26 | 0.335 | 60 |

STAINLESS STEEL 316L PRESS FIT FITTINGS (M PROFILE)

COMPLY WITH BSEN1254-2: 1998



EQUAL TEE

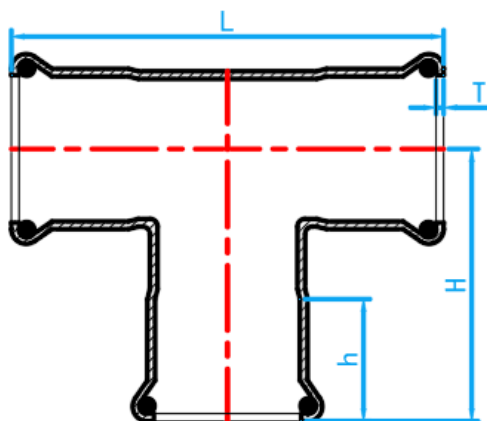
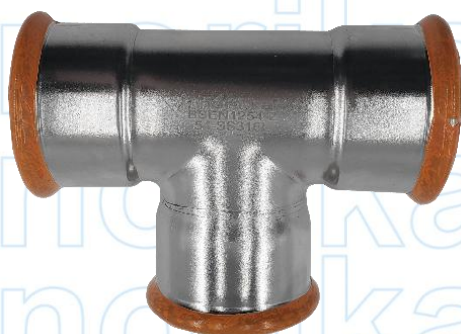

CROSS SECTIONAL VIEW

DIMENSIONS

| SKU | SIZE (mm) | L (mm) | H (mm) | h (mm) | T (mm) | WEIGHT (kg) | PCS/CTN |
|----------------|--------------|-----------|-----------|-----------|-----------|----------------|---------|
| SS316LPFNET015 | 15 | 70 | 36 | 20 | 1.5 | 0.065 | 240 |
| SS316LPFNET020 | 22 | 78 | 40 | 21 | 1.5 | 0.100 | 120 |
| SS316LPFNET025 | 28 | 87 | 45 | 23 | 1.5 | 0.132 | 70 |
| SS316LPFNET035 | 35 | 100 | 53 | 26 | 1.5 | 0.185 | 50 |
| SS316LPFNET042 | 42 | 120 | 61 | 31 | 1.5 | 0.275 | 52 |
| SS316LPFNET050 | 54 | 142 | 73 | 36 | 1.5 | 0.350 | 28 |
| SS316LPFNET065 | 67 | 202 | 98 | 50 | 1.8 | 0.955 | 12 |
| SS316LPFNET080 | 76 | 230 | 110 | 51 | 2.0 | 1.200 | 8 |
| SS316LPFNET100 | 108 | 305 | 160 | 75 | 2.0 | 2.320 | 3 |

STAINLESS STEEL 316L PRESS FIT FITTINGS (M PROFILE)

COMPLY WITH BSEN1254-2: 1998



REDUCING TEE

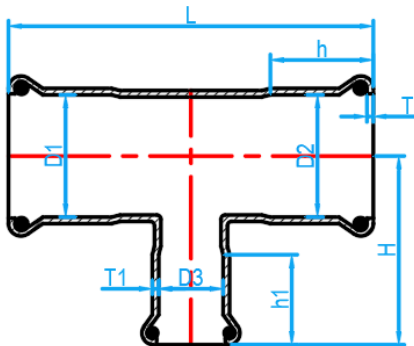
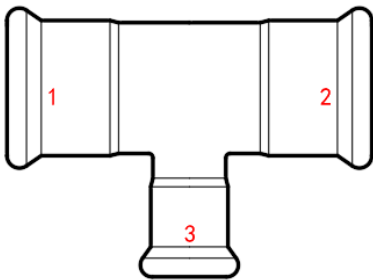

CROSS SECTIONAL VIEW

DIMENSIONS

| SKU | D1×D2×D3 (mm) | L (mm) | H (mm) | h (mm) | h1 (mm) | T (mm) | T1 (mm) | WEIGHT (kg) | PCS/C TN |
|---------------------|------------------|-----------|-----------|-----------|------------|-----------|------------|----------------|-------------|
| SS316LPFNRT0202015 | 22×22×15 | 76 | 38 | 21 | 20 | 1.5 | 1.5 | 0.090 | 120 |
| SS316LPFNRT0252515 | 28×28×15 | 87 | 42 | 23 | 20 | 1.5 | 1.5 | 0.118 | 60 |
| SS316LPFNRT0252520 | 28×28×22 | 87 | 45 | 23 | 21 | 1.5 | 1.5 | 0.134 | 60 |
| SS316LPFNRT0353515 | 35×35×15 | 100 | 46 | 26 | 20 | 1.5 | 1.5 | 0.155 | 80 |
| SS316LPFNRT0353520 | 35×35×22 | 100 | 46 | 26 | 21 | 1.5 | 1.5 | 0.160 | 80 |
| SS316LPFNRT0353525 | 35×35×28 | 100 | 48 | 26 | 23 | 1.5 | 1.5 | 0.170 | 50 |
| SS316LPFNRT0424215 | 42×42×15 | 118 | 52 | 31 | 20 | 1.5 | 1.5 | 0.220 | 51 |
| SS316LPFNRT0424220 | 42×42×22 | 118 | 52 | 31 | 21 | 1.5 | 1.5 | 0.230 | 70 |
| SS316LPFNRT0424225 | 42×42×28 | 118 | 53 | 31 | 23 | 1.5 | 1.5 | 0.230 | 60 |
| SS316LPFNRT0424235 | 42×42×35 | 118 | 56 | 31 | 26 | 1.5 | 1.5 | 0.240 | 50 |
| SS316LPFNRT0505015 | 54×54×15 | 142 | 55 | 36 | 20 | 1.5 | 1.5 | 0.300 | 38 |
| SS316LPFNRT0505020 | 54×54×22 | 142 | 57 | 36 | 21 | 1.5 | 1.5 | 0.320 | 32 |
| SS316LPFNRT0505025 | 54×54×28 | 142 | 56 | 36 | 23 | 1.5 | 1.5 | 0.300 | 32 |
| SS316LPFNRT0505035 | 54×54×35 | 142 | 62 | 36 | 26 | 1.5 | 1.5 | 0.342 | 32 |
| SS316LPFNRT0505042 | 54×54×42 | 142 | 67 | 36 | 31 | 1.5 | 1.5 | 0.360 | 32 |
| SS316LPFNRT0656515 | 67×67×15 | 202 | 65 | 50 | 20 | 1.8 | 1.5 | 0.700 | 15 |
| SS316LPFNRT0656520 | 67×67×22 | 202 | 66 | 50 | 21 | 1.8 | 1.5 | 0.700 | 15 |
| SS316LPFNRT0656525 | 67×67×28 | 202 | 68 | 50 | 23 | 1.8 | 1.5 | 0.720 | 15 |
| SS316LPFNRT0656535 | 67×67×35 | 202 | 72 | 50 | 26 | 1.8 | 1.5 | 0.730 | 15 |
| SS316LPFNRT0656542 | 67×67×42 | 202 | 76 | 50 | 31 | 1.8 | 1.5 | 0.750 | 15 |
| SS316LPFNRT0656550 | 67×67×54 | 202 | 83 | 50 | 36 | 1.8 | 1.5 | 0.850 | 12 |
| SS316LPFNRT0808015 | 76×76×15 | 230 | 69 | 51 | 20 | 2.0 | 1.5 | 0.860 | 12 |
| SS316LPFNRT0808020 | 76×76×22 | 230 | 69 | 51 | 21 | 2.0 | 1.5 | 0.870 | 12 |
| SS316LPFNRT0808025 | 76×76×28 | 230 | 71 | 51 | 23 | 2.0 | 1.5 | 0.870 | 12 |
| SS316LPFNRT0808035 | 76×76×35 | 230 | 77 | 51 | 26 | 2.0 | 1.5 | 0.970 | 12 |
| SS316LPFNRT0808042 | 76×76×42 | 230 | 81 | 51 | 31 | 2.0 | 1.5 | 0.960 | 11 |
| SS316LPFNRT0808050 | 76×76×54 | 230 | 87 | 51 | 36 | 2.0 | 1.5 | 1.030 | 10 |
| SS316LPFNRT0808065 | 76×76×67 | 230 | 105 | 51 | 50 | 2.0 | 1.8 | 1.130 | 10 |
| SS316LPFNRT10010020 | 108×108×22 | 310 | 85 | 75 | 21 | 2.0 | 1.5 | 1.830 | 4 |
| SS316LPFNRT10010025 | 108×108×28 | 310 | 87 | 75 | 23 | 2.0 | 1.5 | 1.840 | 4 |
| SS316LPFNRT10010035 | 108×108×35 | 310 | 91 | 75 | 26 | 2.0 | 1.5 | 1.850 | 4 |
| SS316LPFNRT10010042 | 108×108×42 | 310 | 97 | 75 | 31 | 2.0 | 1.5 | 1.860 | 4 |
| SS316LPFNRT10010050 | 108×108×54 | 310 | 102 | 75 | 36 | 2.0 | 1.5 | 1.870 | 4 |
| SS316LPFNRT10010065 | 108×108×67 | 310 | 120 | 75 | 50 | 2.0 | 1.8 | 1.990 | 3 |
| SS316LPFNRT10010080 | 108×108×76 | 310 | 125 | 75 | 51 | 2.0 | 2.0 | 2.070 | 3 |

STAINLESS STEEL 316L PRESS FIT FITTINGS (M PROFILE)

COMPLY WITH BSEN1254-2: 1998



FI TEE

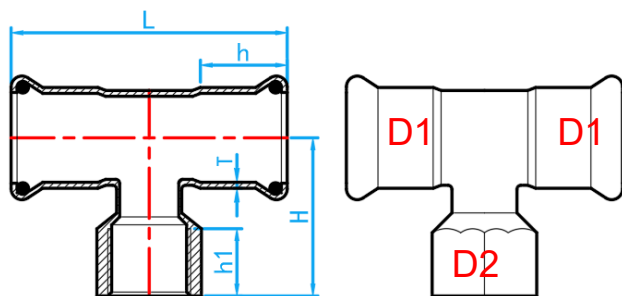
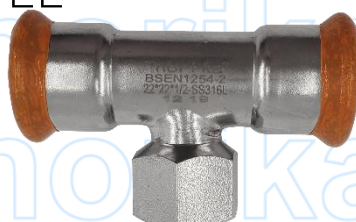

CROSS SECTIONAL VIEW

DIMENSIONS

| SKU | SIZE D1xD1xD2 (mm x mm x inch) | L (mm) | H (mm) | h (mm) | h1 (mm) | T (mm) | WEIGHT (kg) | PCS/CTN |
|--------------------|-----------------------------------|-----------|-----------|-----------|------------|-----------|----------------|---------|
| SS316LPFNFIT01515 | 15×15×1/2" BSP | 70 | 36 | 20 | 15.5 | 1.5 | 0.072 | 150 |
| SS316LPFNFIT02015 | 22×22×1/2" BSP | 76 | 37 | 21 | 15.5 | 1.5 | 0.104 | 140 |
| SS316LPFNFIT02020 | 22×22×3/4" BSP | 76 | 39 | 21 | 16.0 | 1.5 | 0.140 | 120 |
| SS316LPFNFIT02515 | 28×28×1/2" BSP | 87 | 39 | 23 | 15.5 | 1.5 | 0.134 | 80 |
| SS316LPFNFIT02520 | 28×28×3/4" BSP | 87 | 40 | 23 | 16.0 | 1.5 | 0.150 | 60 |
| SS316LPFNFIT02525 | 28 X 28 X 1" BSP | 87 | 45 | 23 | 20.0 | 1.5 | 0.210 | 60 |
| SS316LPFNFIT03506* | 35×35×1/4" BSP | 100 | 42 | 26 | 15.5 | 1.5 | 0.180 | 60 |
| SS316LPFNFIT03515 | 35×35×1/2" BSP | 100 | 42 | 26 | 15.5 | 1.5 | 0.185 | 60 |
| SS316LPFNFIT03520 | 35×35×3/4" BSP | 100 | 54 | 26 | 16.0 | 1.5 | 0.191 | 60 |
| SS316LPFNFIT03525 | 35×35×1" BSP | 100 | 48 | 26 | 20.0 | 1.5 | 0.170 | 60 |
| SS316LPFNFIT03535 | 35×35×11/4" BSP | 100 | 52 | 26 | 21.0 | 1.5 | 0.230 | 40 |
| SS316LPFNFIT04215 | 42×42×1/2" BSP | 118 | 47 | 31 | 15.5 | 1.5 | 0.235 | 60 |
| SS316LPFNFIT04220 | 42×42×3/4" BSP | 118 | 47 | 31 | 16.0 | 1.5 | 0.240 | 48 |
| SS316LPFNFIT04225 | 42×42×1" BSP | 118 | 53 | 31 | 20.0 | 1.5 | 0.265 | 50 |
| SS316LPFNFIT04235 | 42×42×11/4" BSP | 118 | 57 | 31 | 21.0 | 1.5 | 0.300 | 50 |
| SS316LPFNFIT04242 | 42×42×11/2" BSP | 118 | 61 | 31 | 25.0 | 1.5 | 0.310 | 40 |
| SS316LPFNFIT05015 | 54×54×1/2" BSP | 142 | 55 | 36 | 15.5 | 1.5 | 0.330 | 40 |
| SS316LPFNFIT05020 | 54×54×3/4" BSP | 142 | 54 | 36 | 16.0 | 1.5 | 0.357 | 34 |
| SS316LPFNFIT05025 | 54×54×1" BSP | 142 | 59 | 36 | 20.0 | 1.5 | 0.357 | 32 |
| SS316LPFNFIT05035 | 54×54×11/4" BSP | 142 | 62 | 36 | 21.0 | 1.5 | 0.350 | 30 |
| SS316LPFNFIT05042 | 54×54×11/2" BSP | 142 | 64 | 36 | 21.0 | 1.5 | 0.410 | 30 |
| SS316LPFNFIT05050 | 54×54×2" BSP | 142 | 70 | 36 | 25.0 | 1.5 | 0.480 | 32 |
| SS316LPFNFIT06515 | 67×67×1/2" BSP | 202 | 61 | 50 | 15.5 | 1.8 | 0.700 | 18 |
| SS316LPFNFIT06520 | 67×67×3/4" BSP | 202 | 61 | 50 | 16.0 | 1.8 | 0.710 | 15 |
| SS316LPFNFIT06525* | 67×67×1" BSP | 202 | 66 | 50 | 20.0 | 1.8 | 0.720 | 15 |
| SS316LPFNFIT06535* | 67×67×11/4" BSP | 202 | 70 | 50 | 21.0 | 1.8 | 0.765 | 15 |
| SS316LPFNFIT06542* | 67×67×11/2" BSP | 202 | 72 | 50 | 25.0 | 1.8 | 0.800 | 15 |
| SS316LPFNFIT06550* | 67×67×2" BSP | 202 | 78 | 50 | 25.0 | 1.8 | 0.820 | 15 |
| SS316LPFNFIT08015 | 76×76×1/2" BSP | 230 | 66 | 51 | 15.5 | 2.0 | 0.955 | 12 |
| SS316LPFNFIT08020* | 76×76×3/4" BSP | 230 | 66 | 51 | 16.0 | 2.0 | 0.970 | 12 |
| SS316LPFNFIT08025* | 76×76×1" BSP | 230 | 73 | 51 | 20.0 | 2.0 | 0.990 | 12 |
| SS316LPFNFIT10050* | 108×108×2" BSP | 310 | 100 | 75 | 25.0 | 2.0 | 2.050 | 3 |

*This item requires special ordering. Please consult with a salesperson for the estimated lead time.

STAINLESS STEEL 316L PRESS FIT FITTINGS (M PROFILE)

COMPLY WITH BSEN1254-2: 1998



MI TEE

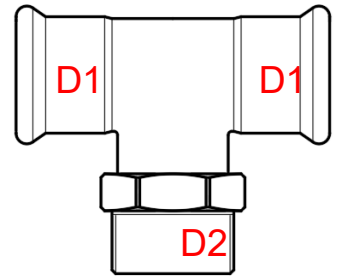
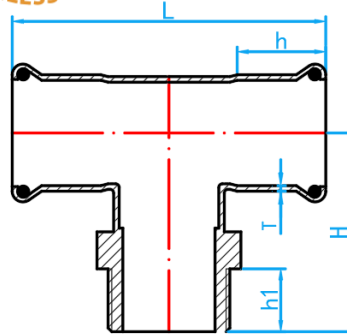
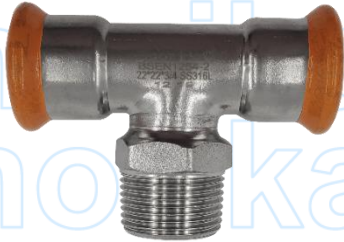

CROSS SECTIONAL VIEW

DIMENSIONS

| SKU | SIZE D1xD1xD2 (mm x mm x inch) | L (mm) | H (mm) | h (mm) | h1 (mm) | T (mm) | WEIGHT (kg) | PCS/CTN |
|--------------------|-----------------------------------|-----------|-----------|-----------|------------|-----------|----------------|---------|
| SS316LPFNMIT01515 | 15×15×1/2" BSPT | 70 | 36 | 20 | 15 | 1.5 | 0.070 | 200 |
| SS316LPFNMIT02015 | 22×22×1/2" BSPT | 76 | 38 | 21 | 15 | 1.5 | 0.090 | 140 |
| SS316LPFNMIT02020 | 22×22×3/4" BSPT | 76 | 43 | 21 | 16 | 1.5 | 0.110 | 100 |
| SS316LPFNMIT02515 | 28×28×1/2" BSPT | 87 | 40 | 23 | 15 | 1.5 | 0.125 | 80 |
| SS316LPFNMIT02520 | 28×28×3/4" BSPT | 87 | 45 | 23 | 16 | 1.5 | 0.140 | 80 |
| SS316LPFNMIT02525 | 28×28×1" BSPT | 87 | 48 | 23 | 18 | 1.5 | 0.160 | 70 |
| SS316LPFNMIT03515 | 35×35×1/2" BSPT | 100 | 46 | 26 | 15 | 1.5 | 0.167 | 50 |
| SS316LPFNMIT03520 | 35×35×3/4" BSPT | 100 | 48 | 26 | 16 | 1.5 | 0.175 | 50 |
| SS316LPFNMIT03525 | 35×35×1" BSPT | 100 | 53 | 26 | 18 | 1.5 | 0.200 | 50 |
| SS316LPFNMIT03535 | 35×35×11/4" BSPT | 100 | 58 | 26 | 20 | 1.5 | 0.250 | 50 |
| SS316LPFNMIT04215 | 42×42×1/2" BSPT | 118 | 50 | 31 | 15 | 1.5 | 0.220 | 48 |
| SS316LPFNMIT04220 | 42×42×3/4" BSPT | 118 | 52 | 31 | 16 | 1.5 | 0.240 | 48 |
| SS316LPFNMIT04225 | 42×42×1" BSPT | 118 | 54 | 31 | 18 | 1.5 | 0.260 | 45 |
| SS316LPFNMIT04235 | 42×42×11/4" BSPT | 118 | 60 | 31 | 20 | 1.5 | 0.300 | 42 |
| SS316LPFNMIT04242 | 42×42×11/2" BSPT | 118 | 62 | 31 | 20 | 1.5 | 0.313 | 35 |
| SS316LPFNMIT05015 | 54×54×1/2" BSPT | 142 | 59 | 36 | 15 | 1.5 | 0.320 | 44 |
| SS316LPFNMIT05020 | 54×54×3/4" BSPT | 142 | 63 | 36 | 16 | 1.5 | 0.340 | 40 |
| SS316LPFNMIT05025 | 54×54×1" BSPT | 142 | 66 | 36 | 18 | 1.5 | 0.360 | 32 |
| SS316LPFNMIT05035 | 54×54×11/4" BSPT | 142 | 67 | 36 | 20 | 1.5 | 0.401 | 35 |
| SS316LPFNMIT05042 | 54×54×11/2" BSPT | 142 | 68 | 36 | 20 | 1.5 | 0.420 | 30 |
| SS316LPFNMIT05050 | 54×54×2" BSPT | 142 | 76 | 36 | 23 | 1.5 | 0.485 | 28 |
| SS316LPFNMIT06525 | 67×67×1" BSPT | 202 | 71 | 52 | 18 | 1.8 | 0.745 | 10 |
| SS316LPFNMIT06550 | 67×67×2" BSPT | 202 | 82 | 55 | 25 | 1.8 | 0.925 | 10 |
| SS316LPFNMIT06565 | 67×67×21/2" BSPT | 202 | 84 | 55 | 28 | 1.8 | 1.005 | 10 |
| SS316LPFNMIT08050* | 76×76×2" BSPT | 230 | 88 | 55 | 27 | 2.0 | 1.130 | 10 |
| SS316LPFNMIT10050* | 108×108×2" BSPT | 310 | 105 | 80 | 27 | 2.0 | 2.040 | 3 |
| SS316LPFNMIT10080* | 108×108×3" BSPT | 310 | 110 | 80 | 30 | 2.0 | 2.410 | 3 |

*This item requires special ordering. Please consult with a salesperson for the estimated lead time.

STAINLESS STEEL 316L PRESS FIT FITTINGS (M PROFILE)

COMPLY WITH BSEN1254-2: 1998



REDUCING CROSS TEE MXF

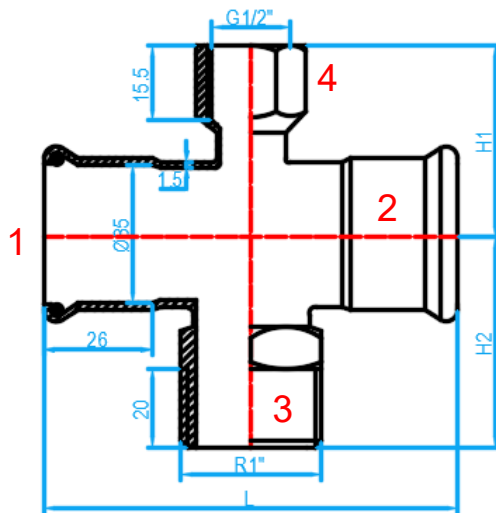

CROSS SECTIONAL VIEW

DIMENSIONS

| STOCK CODE | SIZE (mm x mm x inch x inch) | L (mm) | H1 (mm) | H2 (mm) | WEIGHT (kg) | PCS/CTN |
|----------------------|---------------------------------|-----------|------------|------------|----------------|---------|
| SS316LPFNCT3525M15F* | 35X35X1"BSPTX1/2"BSP | 100 | 43 | 54 | 0.241 | 30 |

*This item requires special ordering. Please consult with a salesperson for the estimated lead time.

STAINLESS STEEL 316L PRESS FIT FITTINGS (M PROFILE)

COMPLY WITH BSEN1254-2: 1998



Cross Over

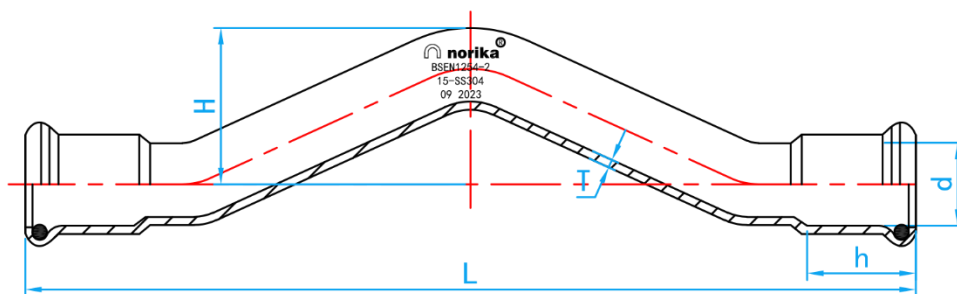

CROSS SECTIONAL VIEW

DIMENSIONS

| SKU | DN mm | d (mm) | L (mm) | H (mm) | h (mm) | T (mm) | WEIGHT (kg) | PCS/CTN |
|----------------|----------|-----------|-----------|-----------|-----------|-----------|----------------|---------|
| SS316LPFNC0015 | 15 | 15 | 168 | 32.5 | 20 | 1.5 | 0.110 | 250 |
| SS316LPFNC0020 | 22 | 22 | 168 | 40.5 | 21 | 1.5 | 0.142 | 150 |
| SS316LPFNC0025 | 28 | 28 | 196 | 47.5 | 23 | 1.5 | 0.220 | 100 |

STAINLESS STEEL 316L PRESS FIT FITTINGS (M PROFILE)

COMPLY WITH BSEN1254-2: 1998



END CAP

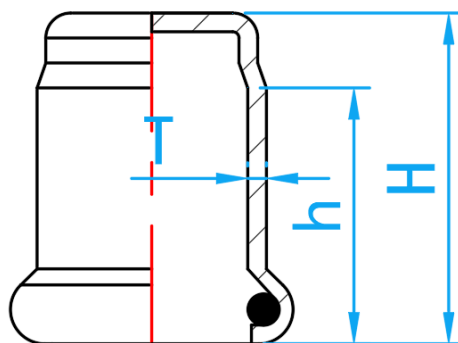

CROSS SECTIONAL VIEW

DIMENSIONS

| SKU | SIZE (mm) | H (mm) | h (mm) | T (mm) | WEIGHT (kg) | PCS/CTN |
|----------------|--------------|-----------|-----------|-----------|----------------|---------|
| SS316LPFNEC015 | 15 | 35 | 20 | 1.5 | 0.024 | 500 |
| SS316LPFNEC020 | 22 | 35 | 21 | 1.5 | 0.041 | 300 |
| SS316LPFNEC025 | 28 | 38 | 23 | 1.5 | 0.059 | 200 |
| SS316LPFNEC035 | 35 | 41 | 26 | 1.5 | 0.077 | 180 |
| SS316LPFNEC042 | 42 | 48 | 31 | 1.5 | 0.106 | 120 |
| SS316LPFNEC050 | 54 | 52 | 36 | 1.5 | 0.153 | 84 |
| SS316LPFNEC065 | 67 | 72 | 50 | 1.8 | 0.280 | 65 |
| SS316LPFNEC080 | 76 | 83 | 51 | 2.0 | 0.410 | 36 |
| SS316LPFNEC100 | 108 | 107 | 75 | 2.0 | 0.715 | 12 |

STAINLESS STEEL 316L PRESS FIT FITTINGS (M PROFILE)

COMPLY WITH BSEN1254-2: 1998



PRESSFIT FLANGE REDUCE SOCKET

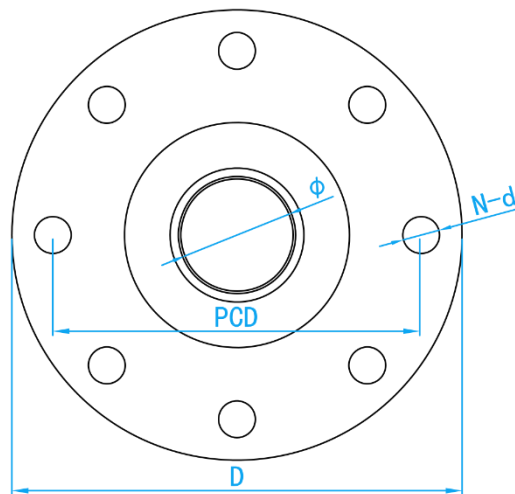

TOP VIEW

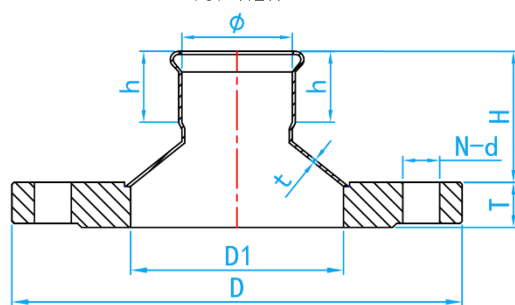

CROSS SECTIONAL VIEW

DIMENSIONS

| SKU | Ø (mm) | D (mm) | PCD (mm) | D1 (mm) | NO.S OF HOLS | d (mm) | T (mm) | H (mm) | h (mm) | t (mm) | WEIGHT (kg) |
|--------------------|-----------|-----------|-------------|------------|-----------------|-----------|-----------|-----------|-----------|-----------|----------------|
| SS316LPFNFLS06550 | 54 | 185 | 145 | 63 | 4 | 18 | 20 | 53 | 36 | 1.8 | 3.19 |
| SS316LPFNFLS08050 | 54 | 200 | 160 | 85 | 8 | 18 | 20 | 59 | 36 | 1.5 | 3.92 |
| SS316LPFNFLS08065 | 67 | 200 | 160 | 85 | 8 | 18 | 20 | 71 | 50 | 1.8 | 4.02 |
| SS316LPFNFLS100050 | 54 | 220 | 180 | 104 | 8 | 18 | 20 | 67 | 36 | 1.5 | 4.31 |
| SS316LPFNFLS100065 | 67 | 220 | 180 | 104 | 8 | 18 | 20 | 85 | 50 | 1.8 | 4.42 |
| SS316LPFNFLS100080 | 76 | 220 | 180 | 104 | 8 | 18 | 20 | 85 | 53 | 2.0 | 4.46 |
| SS316LPFNFLS150065 | 67 | 285 | 240 | 154 | 8 | 22 | 24 | 116 | 50 | 1.8 | 8.20 |
| SS316LPFNFLS150080 | 76 | 285 | 240 | 154 | 8 | 22 | 24 | 121 | 53 | 2.0 | 8.23 |
| SS316LPFNFLS150100 | 108 | 285 | 240 | 154 | 8 | 22 | 24 | 140 | 75 | 2.0 | 8.48 |

STAINLESS STEEL 316L PRESS FIT FITTINGS (M PROFILE)

COMPLY WITH BSEN1254-2: 1998



PRESSFIT FLANGE SOCKET

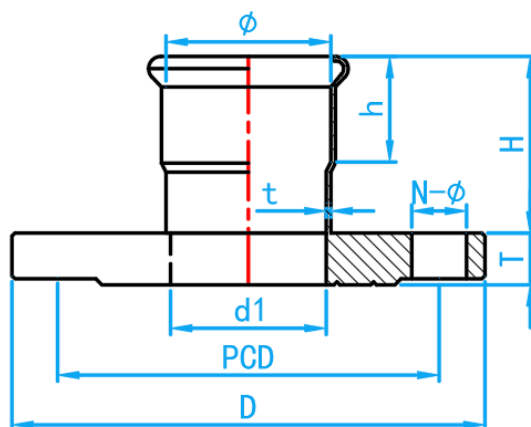

CROSS SECTIONAL VIEW

DIMENSIONS

| STOCK CODE | Ø (mm) | D (mm) | PCD (mm) | d1 (mm) | NO.S OF HOLS | d (mm) | T (mm) | H (mm) | h (mm) | t (mm) | WEIGHT (kg) |
|--------------------|-----------|-----------|-------------|------------|-----------------|-----------|-----------|-----------|-----------|-----------|----------------|
| SS316LPFNFLS01515* | 15 | 95 | 65 | 12 | 4 | 14 | 14 | 31 | 20 | 1.5 | 0.640 |
| SS316LPFNFLS02020* | 22 | 105 | 75 | 18 | 4 | 14 | 16 | 35 | 21 | 1.5 | 0.940 |
| SS316LPFNFLS02525 | 28 | 115 | 85 | 25 | 4 | 14 | 16 | 40 | 23 | 1.5 | 1.140 |
| SS316LPFNFLS03535 | 35 | 130 | 100 | 32 | 4 | 18 | 18 | 45 | 26 | 1.5 | 1.840 |
| SS316LPFNFLS04242 | 42 | 140 | 110 | 39 | 4 | 18 | 18 | 54 | 31 | 1.5 | 2.150 |
| SS316LPFNFLS05050 | 54 | 155 | 125 | 51 | 4 | 18 | 19 | 67 | 36 | 1.5 | 2.720 |
| SS316LPFNFLS06565 | 67 | 175 | 145 | 72 | 4 | 18 | 18 | 67 | 50 | 1.8 | 3.640 |
| SS316LPFNFLS08080 | 76 | 190 | 160 | 85 | 8 | 18 | 20 | 73 | 51 | 2.0 | 4.140 |
| SS316LPFNFLS100100 | 108 | 210 | 180 | 104 | 8 | 18 | 22 | 86 | 75 | 2.0 | 4.710 |

*This item requires special ordering. Please consult with a salesperson for the estimated lead time.

STAINLESS STEEL 316L PRESS FIT FITTINGS

COMPLY WITH BSEN1254-2: 1998

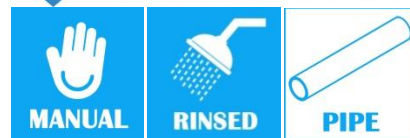

FLANGE SOCKET

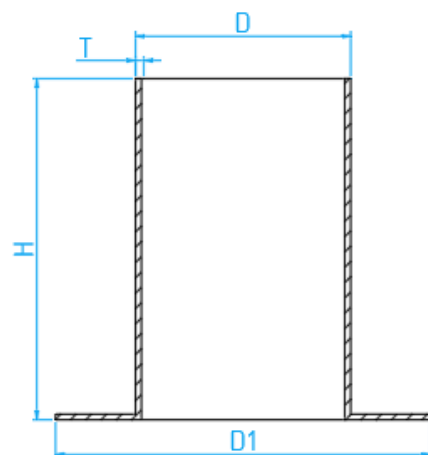

CROSS SECTIONAL VIEW

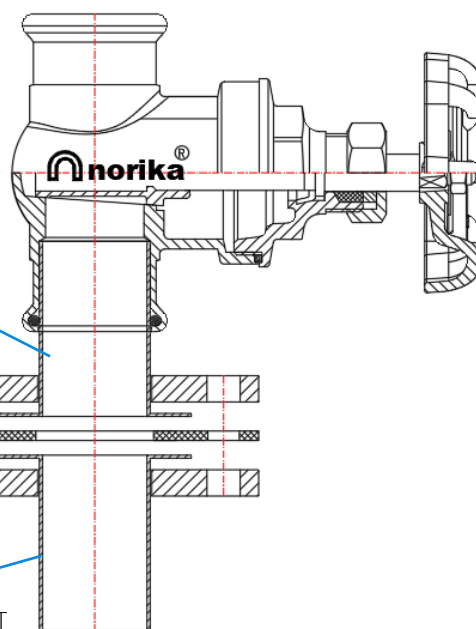

INSTALLATION ASSEMBLY

- SS316L FLANGE SOCKET
SKU:SS316LPFNFS
- DUCTILE IRON FLANGE
SKU: DIFMBL
- EPDM RUBBER GASKET
SKU: RFGN-PUB
- DUCTILE IRON FLANGE
SKU: DIFMBL
- SS316L FLANGE SOCKET
SKU:SS316LPFNFS

DIMENSIONS

| SKU | DN (mm) | D (mm) | D1 (mm) | H (mm) | T (mm) | WEIGHT (kg) | PCS/CTN |
|----------------|------------|-----------|------------|-----------|-----------|----------------|---------|
| SS316LPFNFS042 | 42 | 42.07 | 97 | 90 | 1.5 | 0.265 | 30 |
| SS316LPFNFS050 | 54 | 54.07 | 107 | 100 | 1.5 | 0.352 | 45 |
| SS316LPFNFS065 | 67 | 66.75 | 127 | 140 | 1.8 | 0.635 | 19 |
| SS316LPFNFS080 | 76 | 76.30 | 142 | 150 | 2.0 | 0.780 | 14 |
| SS316LPFNFS100 | 108 | 108.25 | 160 | 190 | 2.0 | 1.180 | 8 |

STAINLESS STEEL 316L PRESSFIT SINGLE SIDED MANIFOLDS

COMPLY WITH BSEN1254-2: 1998

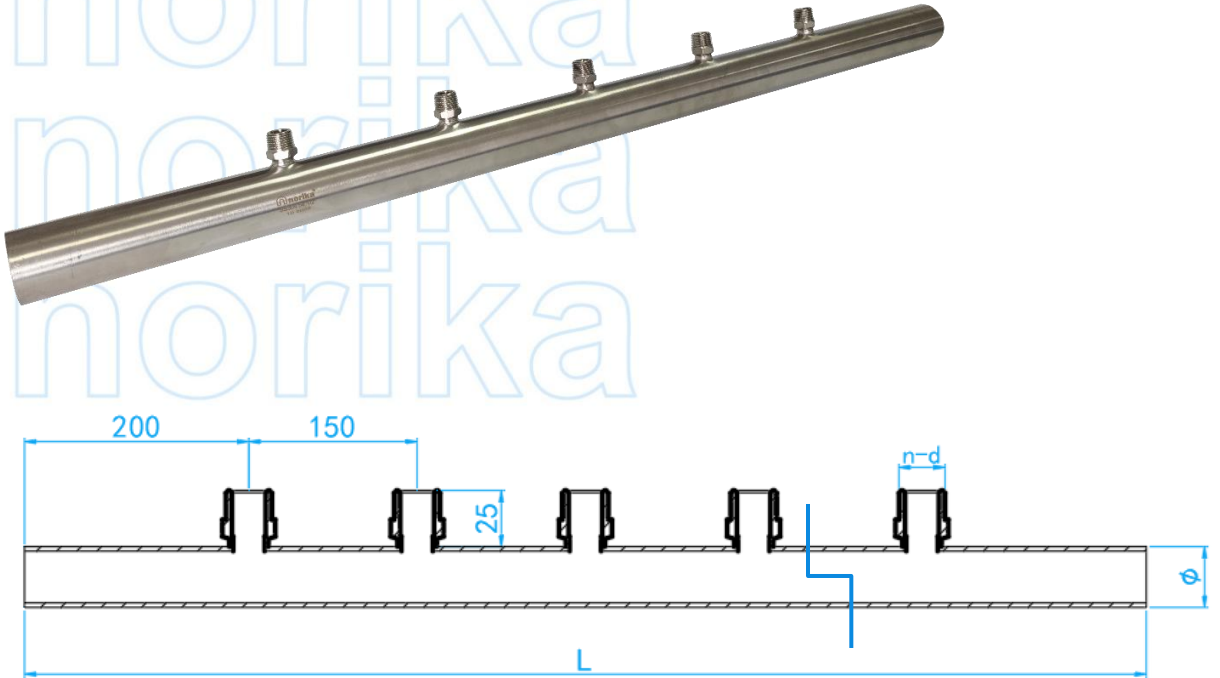
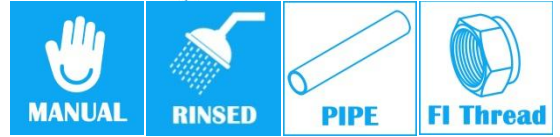

CROSS SECTIONAL VIEW

* Size could be customized.

| DIMENSIONS | | | | |
|--------------------|---------------------|----------------|-----------|----------------|
| SKU | Ø×Thickness (mm) | n-d | L (mm) | WEIGHT (kg) |
| SS316LNM05015MX03* | 54×1.5 | 3NOS -G1/2" MI | 700 | 1.395 |
| SS316LNM05015MX04* | 54×1.5 | 4NOS -G1/2" MI | 850 | 1.715 |
| SS316LNM05015MX05* | 54×1.5 | 5NOS--G1/2" MI | 1000 | 2.050 |

*This item requires special ordering. Please consult with a salesperson for the estimated lead time.

STAINLESS STEEL 316L PRESSFIT SINGLE SIDED MANIFOLDS

COMPLY WITH BSEN1254-2: 1998

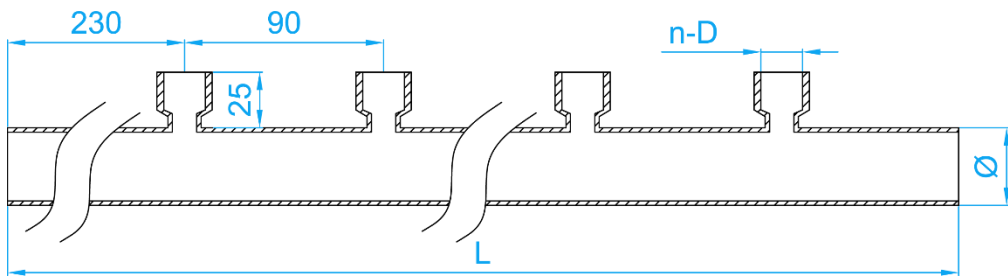
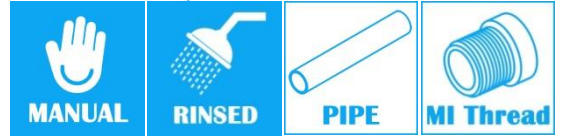

CROSS SECTIONAL VIEW

* Size could be customized.

DIMENSIONS

| SKU | Ø×Thickness (mm) | n-D | L (mm) | WEIGHT (kg) |
|--------------------|---------------------|----------------|-----------|----------------|
| SS316LNM03515FX04* | 35×1.5 | 4NOS -G1/2" FI | 1000 | 1.450 |

*This item requires special ordering. Please consult with a salesperson for the estimated lead time.

Built For Water



Main Office

133 Kitchener Road
Singapore 208517

Mon-Fri: 8:00am - 5:30pm
Sat: 8:00am - 1:00pm
Sun & PH: Closed

North Office

10 Admiralty Street, North
Link Building #02-45
Singapore 757695

Mon-Fri: 8:00am - 5:00pm
Sat: 8:00am - 1:00pm
Sun & PH: Closed