

WC CONCEAL AUTO SENSOR FLUSHING SYSTEM

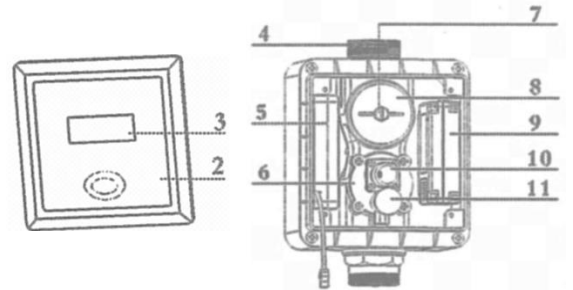

COMPONENT PARTS

ITEM	PARTS	MATERIAL
1	Pre-embedded board	
2	Control Panel	AISI304
3	Sensing window	ABS
4	Inlet	Brass
5	Battery Compartment	ABS
6	Priority valve	Brass
7	Stop knob	ABS
8	Filter cover	ABS
9	Power supply adapter	ABS
10	Solenoid valve	Steel & Brass
11	Manual button	Brass
12	Inlet tie-in	Brass
13	Gasket	NBR
14	Inlet nut	Brass
15	Outlet connected nut with seal	Brass
16	Manual button (10mm)	Brass
17	Power wire	Copper

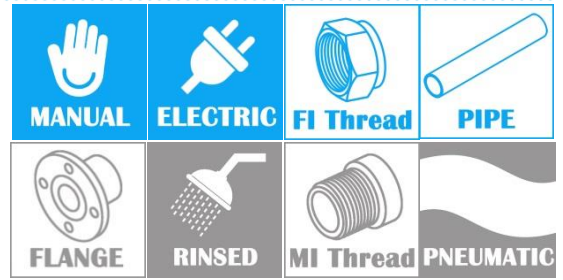
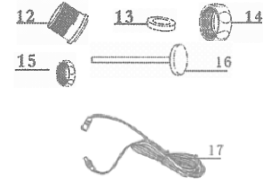
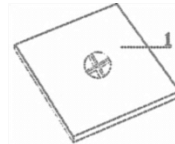

CHARACTERISTIC

- Intelligent user-friendly sensing with manual over-riding option for convenience.
- Invisible locking mechanism and stainless steel satin finish for stylish aesthetic look.
- Fully water and moisture proof for reliability and resilience.
- The automatic flushing feature ensure that your washroom is rid of odour at all time.

STANDARD SPECIFICATIONS

SKU	SIZE (mm)	POWER SUPPLY	SENSOR DISTANCE
AFVN3700AD	130(L) X 130(H) X 100(W)	220V - 240V	800mm to 900mm

STANDARD SPECIFICATIONS

PERIPHERAL TEMPERATURE RANGE	OPERATIONAL PRESSURE	VOLUME OF DISCHARGE	FLUSHING TIME	WEIGHT (kg)	PCS/CTN
0-55°C	2-5 Bar	3.5 to 4.5 Litres	5 to 10 sec	1.72	4