

PEX MULTI LAYER PIPES AND FITTINGS



COMPLY WITH BS EN ISO 21003-1:2008
 BS EN ISO 21003-3:2008
 BS EN ISO 21003-5:2008
 BS EN 12165:2016
 AS/NZS 4020:2005
 SS 375:2015



F6 PUSH-FIT PEX EQUAL SOCKET

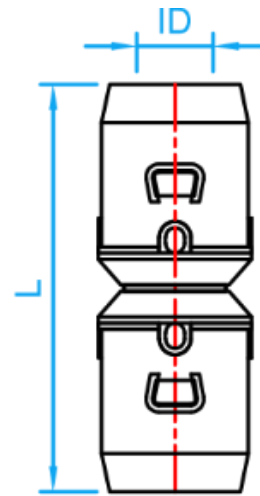

SIDE VIEW

DIMENSIONS

SKU	SIZE (mm)	ID (mm)	L (mm)	WEIGH (kg)	PCS/CTN
PEXF6ES16	16	11.80	64.0	0.066	144
PEXF6ES20	20	15.80	67.0	0.096	120
PEXF6ES25	25	19.75	77.5	0.150	96
PEXF6ES32	32	25.75	88.5	0.249	48